

# apex series



Apex adapts to the activities of individuals and groups, creating a workplace that compels achievement. Available in our 20 standard colors.

## Features

Modern, contemporary style. Standard grommets, face lock and handles on all pedestals.

### Handle

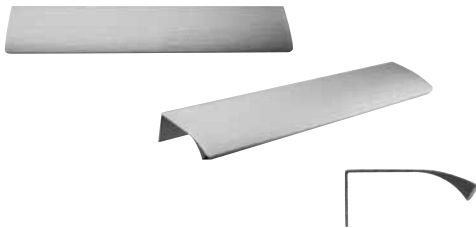

**APH1**  
Smooth, curved edge handle in brushed aluminum  
(Standard Apex handles)

### Grommet

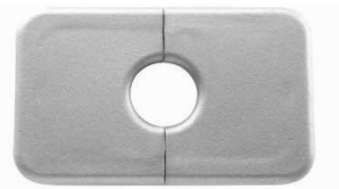

**APRG1S**  
Standard Rectangular Grommet - Silver

# apex series

**15** DAYS and **20** DAYS Lead Time

## Product Specifications

### Colors

- 20 standard colors are available. Two colors may be specified at no charge.
- See color chart for upcharge information.

### Top / Worksurfaces

- 1" TFM (Thermally Fused Melamine) on industrial quality (45 lb.) particleboard.
- 2 mm thermally-fused PVC edge banding.
- Woodgrain direction on tops is horizontal.

### Chassis Construction

- TFM chassis fastened by screws, steel brackets, and/or concealed fasteners.
- Adjustable leveling glides are provided on all units.
- Apex Series shipped with temporary nail glides - remove at time of installation.
- Chassis are all 3/4" material including low credenza and free-standing storage tower.

### Drawer Interiors

- 9-ply Birch wood drawers

### Drawer Suspension, Construction and Doors

- Drawers have full-extension, progressive-action slides with precision steel ball bearings.
- APH1 handles standard.
- Overlay drawer front and doors are standard on all separate storage units and separate file units.
- All file and lateral drawers file legal size from side to side and letter front to back.
- File drawer construction accommodates hanging files not stacked material on drawer bottom.
- Hutch doors overlay.

### Cord Management

- A grommet is standard on all worksurfaces.
- Optional wire management is available.

### Locks

- Locks standard on all support pedestals.
- Silver, removable cores are standard for all locks.
- Pedestal key numbers are randomly assigned to all locking pedestals.
- Key alike lock numbers (#101-115) may be specified at no charge.
- Master keys and keyed-alike combinations are available.

**Disclaimer:** Dimensions assigned in this price list are nominal. If exact measurements are required, the requirement must be specified in the order and specifically acknowledged by Maverick. Maverick reserves the right to change construction details and standards without notification, if necessary.

**Line drawings shown are resemblance to finish product. Product designs may vary.**

## How to Order Apex Series

### WORKSURFACE UNITS: TOPS, BASES, SUPPORTS

1. Product number: **AP WT 24 72 30R**

Depth (Right)  
 Width  
 Depth  
 Product Type: Worksurface (Wedge)  
 Series Name: Apex

2. Specify worksurface and chassis finish.
3. Specify drawer or door front finish (matching color edge band is standard). For two colors, add \$102 list.
4. Specify data/power management. See page 202.

#### WORKSURFACES (P. 179-184)

- Available in 20 colors  
Specify **APWT 2 4 7 2 3 0 R**

#### PRIVACY SCREENS (P. 190-191)

- Frosted acrylic screens are mounted to worksurfaces.  
Specify **APPSU 7 2**

#### LOW CREDENZA SUPPORT (P. 188)

- Attaches to worksurfaces to add support between low credenzas and tops.  
Specify **APSLEG 2 4**

#### LOW CREDENZAS (P. 193-194)

- Available in a myriad of configurations to meet several storage considerations  
Specify **APSBL 2 0 7 2 R**



#### WORKSURFACE SUPPORTS (P.185-189)

- Worksurface support legs are ordered separately
- Required for supporting available Apex worksurfaces  
Specify **APODL 3 0**



SILVER GROMMET (APRG1S)



HANDLE (APH1)

# apex series

## Power Management

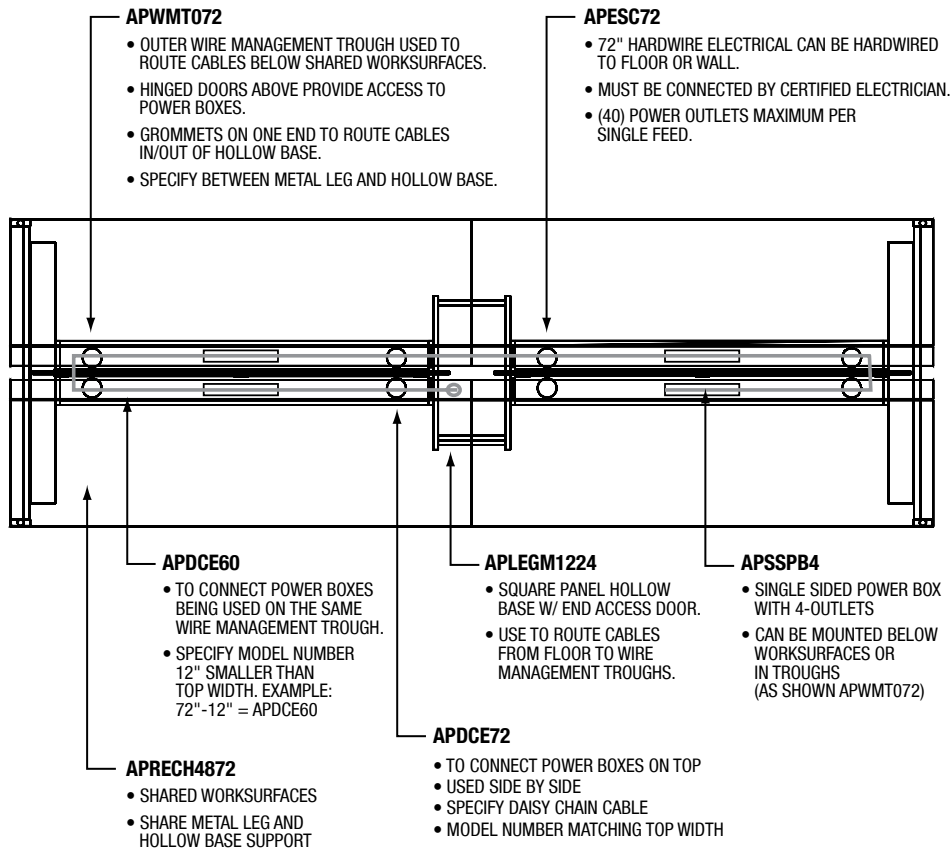

# apex series

## Statement of Line

### WORKSURFACES

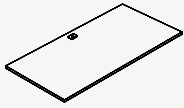

Rectangular  
(APRT\_\_\_\_\_)

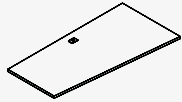

Wedge  
(APWT\_\_\_\_\_)

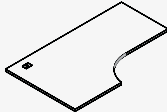

Extended Compu-Corner  
(APET\_\_\_\_\_)



Compu-Corner Angled  
(APAT\_\_\_\_\_)



Bullet  
(APBD\_\_\_\_\_)



Saddle Compu-Corner  
(APST\_\_\_\_\_)

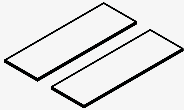

Rectangular Shared  
(APRECH\_\_\_\_\_)

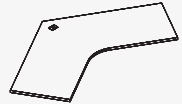

Corner  
(APCCU\_\_\_\_\_)

### WORKSURFACE SUPPORTS



External Stabilizer Bar  
(APSB\_)

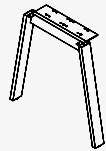

Apron Leg  
(APOAL\_)

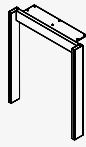

Double Post  
(APODPL\_)

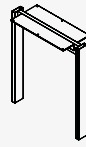

Shared Double Post Leg  
(APDPLM\_)

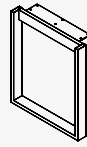

D-Leg  
(APODL\_)

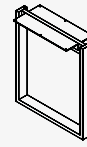

Shared D-Leg  
(APMDL\_)



28" Single Post  
(APSPL28)

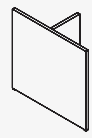

T-Leg  
(APTEG\_)

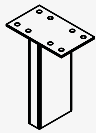

6" Single Post  
(APSPL6)

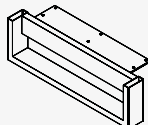

Short D-Leg  
(APOSDL\_)

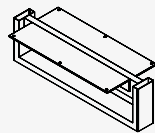

Short D-Leg (Shared)  
(APMSDL\_)

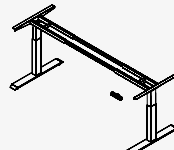

Adjustable Height Electrical Base  
(MMLEGAHE\_)

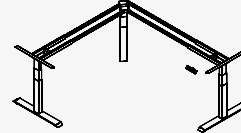

Adjustable Height Electrical Base  
(MMLEGAHEL\_)

### SUPPORT PEDESTALS

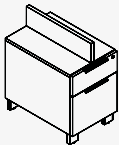

Box/File  
(APPEDA\_\_BF)

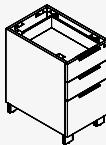

Box/Box/File  
(APPEDC\_\_BBF)

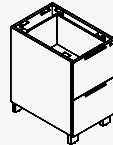

File/File  
(APPEDD\_\_FF)

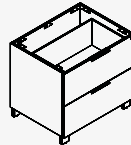

Lateral File  
(APPED\_\_\_LF)

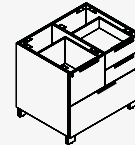

Personal Lateral File  
(APPED\_\_\_PLF)

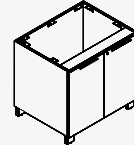

Hinged Door Cabinet  
(APPED\_\_\_HDC)

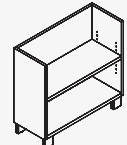

Bookcase Pedestal  
(APPEDBC\_)

### LOW CREDENZAS

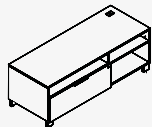

Single Lateral File  
(APSL0\_\_\_\_\_)

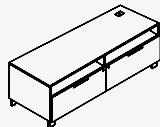

Double Lateral File  
(APDOL\_\_\_\_\_)

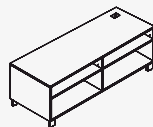

Open  
(APDO\_\_\_\_\_)

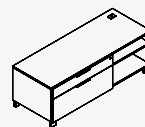

Single Box/Lateral  
(APSBL\_\_\_\_\_)

# apex series

## Statement of Line

### HUTCH AND WALL MOUNT CABINET

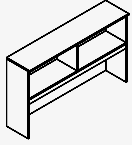

Open Hutch (No Doors)  
(APH \_\_ND)

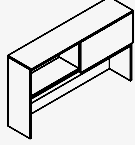

Hutch (One Sliding Door)  
(APH \_\_HS)

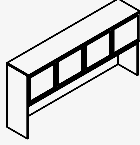

Hutch (Frosted Glass Doors)  
(APH \_\_WG)

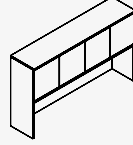

Hutch (Laminate Hinged Doors)  
(APH \_\_WD)

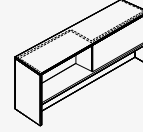

Hutch (Two-sided)  
(APHSB \_\_)

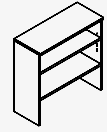

Bookcase Hutch  
(APBCH)

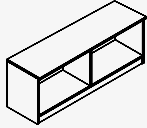

Wall Mount (Overhead)  
No Doors  
(APCFHO \_\_)

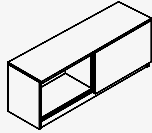

Wall Mount (Overhead)  
One Sliding Door  
(APCFHS \_\_)

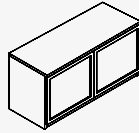

Wall Mount (Overhead)  
Frosted Glass Doors  
(APCFHG \_\_)

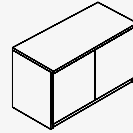

Wall Mount (Overhead)  
Laminate Hinged Doors  
(APCFHD \_\_)

### FREESTANDING STORAGE

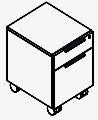

Pedestal  
(APPED AX \_\_BF)

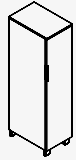

Single Cabinet  
(APSTS \_\_ \_\_)

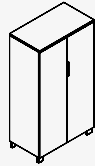

Double Cabinet  
(APDST \_\_ \_\_)

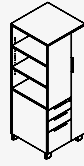

Personal Bookcase  
(APPBSC \_\_ \_\_)



Single (Box/Box/File)  
(APBCV \_\_ \_\_)

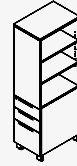

Personal Cabinet  
(APBCPS \_\_ \_\_)

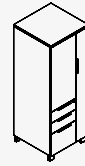

Personal Wardrobe  
(APWCP \_\_ \_\_)

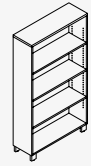

Bookcase  
(APBC \_\_)

### PRIVACY SCREENS

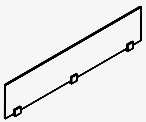

Frosted Acrylic Screen  
(APPSU \_\_)

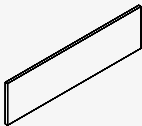

TFM Privacy Screen  
(APPSUW \_\_ \_\_)

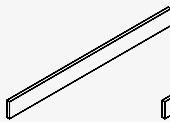

(TFM) Extension  
(APPSUW \_\_ \_\_)

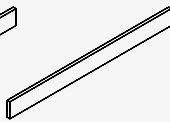

(HPL) Extension  
(APPSUHP \_\_ \_\_)



Privacy Panel  
(APPANEL \_\_ \_\_)

### MODESTIES

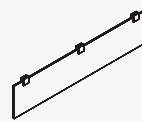

Frosted Acrylic Modesty  
(APPSL \_\_)

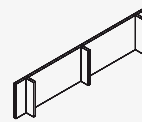

(TFM) Modesty  
(APPSLW \_\_)

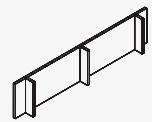

(HPL) Modesty  
(APPSLHP \_\_)

### TACKBOARDS AND CUSHIONS

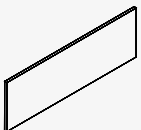

Tackboard  
(APTKBD19 \_\_)

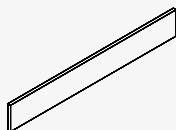

Tackboard (Lower)  
(APTKBD08 \_\_)

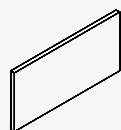

Tackboard (Upper)  
(APTKBD15 \_\_)

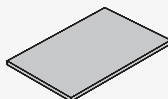

Cushion  
(APCUH \_\_ \_\_)

### BASES

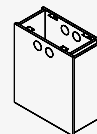

Square Panel (Hollow, End Access)  
(APLEGM \_\_)

# apex series

## Statement of Line

### FREESTANDING TROUGHS

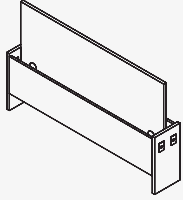

Trough with Center Panel

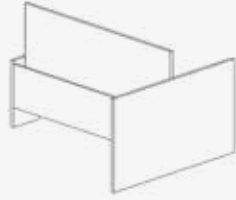

Trough with Center Panel & End Panel

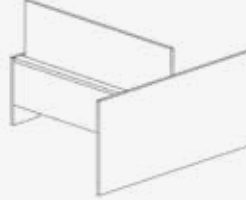

Trough with Doors, Center Panel & End Panel

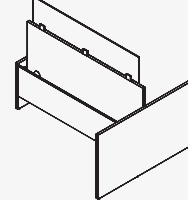

Trough with Center Panel, Privacy Screen & End Panel

### CONFERENCE



Boatshape  
(APBS\_...)



Rectangular  
(APRE\_...)

### WIRE MANAGEMENT

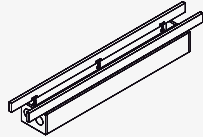

Middle Wire Management Trough  
(APWMTM\_...)

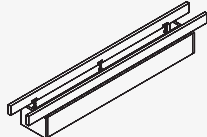

Outer Wire Management Trough  
(APWMT0\_...)

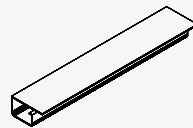

Plastic Wire Management Trough  
(APPWM18)

### DATA / POWER MANAGEMENT



Starter Cable  
(APESC72)



Daisy Chain Cable  
(APDCE\_...)

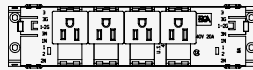

Power Box (4 Outlet)  
(APSSPB4)



Power Box (8 Outlet)  
(APSSPB8)

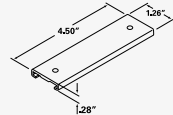

Vertibrate Wiring Module  
(APVMT28)



Grommet  
(APRPG1GW)

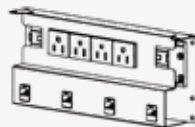

Power Module (4 Power, 4 RJ45)  
(APBSB4)

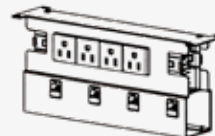

Power Module (8 Power, 4 RJ45)  
(APSD8)



Tasklight  
(APSKLTX24)



# apex series

## Configurations

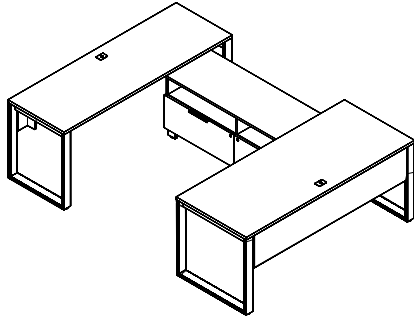

AP1L				
Qty	Model #	Description	List price	Extended Price
1	APRT3072	Rectangular Top Worksurface	\$455	\$455
1	APRT2472	Rectangular Top Worksurface (24"x72")	\$407	\$407
2	APODL30	D-Leg (30"Dx28"H)	\$485	\$970
2	APODL24	D-Leg (24"Dx28"H)	\$458	\$916
2	APSB72	External Stabilizer Bar (56"W)	\$99	\$198
2	APPSLHP72	HPL Modesty Panel (12"Hx65"W)	\$292	\$584
1	APODL2061L	Low Double Lateral File Credenza, Left (20"Hx61"Dx22"H)	\$2,227	\$2,227
<b>Total</b>			<b>\$2,227</b>	<b>\$2,227</b>
<b>Total</b>			<b>\$5,757</b>	<b>\$5,757</b>

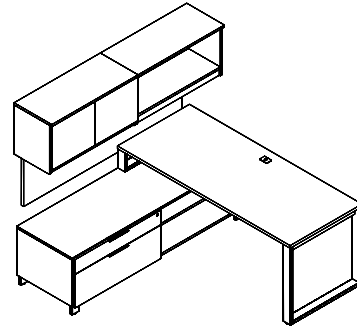

AP2L				
Qty	Model #	Description	List price	Extended Price
1	APRT3072	Rectangular Top Worksurface (30"x72")	\$455	\$455
1	APODL30	D-Leg (30"Dx28"H)	\$485	\$485
1	APOSDL30	Short D-leg (30"Dx6"H)	\$511	\$511
2	APSB72	External Stabilizer Bar (56"W)	\$99	\$198
1	APSBL2472L	Low Single Box/Lateral Credenza, Left (24"Dx72"Wx22"H)	\$2,227	\$2,227
1	APCF0HD36	Wall Mounted Overhead Cabinet with Hinged Doors	\$936	\$936
1	APCF0H036	Wall Mounted Overhead Cabinet with no Doors	\$740	\$740
1	APTKBD1972	Tackboard (70"Wx19"H)	\$643	\$643
<b>Total</b>			<b>\$6,433</b>	<b>\$6,433</b>
<b>Total</b>			<b>\$6,195</b>	<b>\$6,195</b>

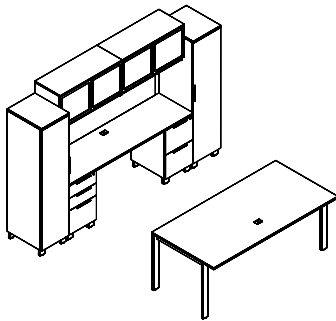

AP3				
Qty	Model #	Description	List price	Extended Price
1	APRT3672	Rectangular Top Worksurface (36"Dx72"W)	\$494	\$494
1	APRT2072	Rectangular Top Worksurface (20"Dx72"W)	\$389	\$389
2	APODPL30	Double Post Leg (30"Dx28"H)	\$399	\$798
2	APSB72	External Stabilizer (56"W)	\$99	\$198
1	APPEDC20BBF	Supporting Box/Box/File, No Top (20"Dx16"Wx28"H)	\$1,289	\$1,289
1	APPEDD20FF	Supporting File/File, No Top (20"Dx16"Wx28"H)	\$1,219	\$1,219
2	APCF0HG36	Wall Mounted Overhead Cabinet with Frosted Glass Doors (14 3/4"Dx36"Wx18 1/2"H)	\$1,127	\$2,254
1	APTKBD1972	Tackboard (70"Wx19"H)	\$643	\$643
1	APSTS2065L	Single Storage Cabinet, Left (20"Dx16"Wx65"H)	\$1,704	\$1,704
1	APSTS2065R	Single Storage Cabinet, Right (20"Dx16"Wx65"H)	\$1,704	\$1,704
<b>Total</b>			<b>\$1,704</b>	<b>\$1,704</b>
<b>Total</b>			<b>\$10,692</b>	<b>\$10,692</b>

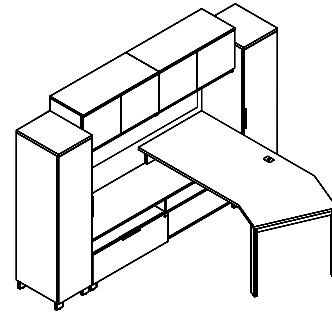

AP4L				
Qty	Model #	Description	List price	Extended Price
1	APAT3072R	Angle Compu-Corner Worksurface (30"Dx72"W)	\$620	\$620
1	APODPL30	Double Post Leg (30"Dx28"H)	\$399	\$399
1	APTLEG3006	Support T-Leg TFM (22"Dx13"Wx6"H)	\$158	\$158
2	APSB72	External Stabilizer Bar (56"W)	\$99	\$198
1	APSL02072L	Low Single Lateral Credenza, Left (20"Dx72"Wx22"H)	\$2,097	\$2,097
2	APCF0HD36	Wall Mounted Overhead Cabinet with Hinged Doors	\$936	\$1,872
1	APTKBD1972	Tackboard (70"Wx19"H)	\$643	\$643
1	APSTS2065L	Single Storage Cabinet, Left (20"Dx16"Wx65"H)	\$1,704	\$1,704
1	APSTS2065R	Single Storage Cabinet, Right (20"Dx16"Wx65"H)	\$1,704	\$1,704
<b>Total</b>			<b>\$1,704</b>	<b>\$1,704</b>
<b>Total</b>			<b>\$9,395</b>	<b>\$9,395</b>



# apex series

## Configurations

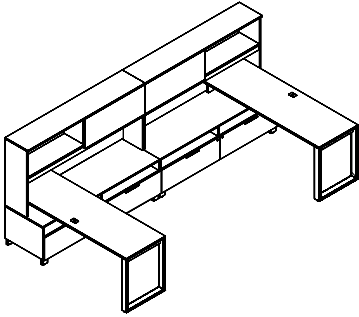

AP5				
Qty	Model #	Description	List price	Extended Price
2	APRT2472	Rectangular Top Worksurface (24"x72")	\$407	\$814
2	APODL24	D-Leg (16"Dx28"H)	\$458	\$916
2	APTLEG2406	Support T-Leg TFM (16"Dx13"Wx6"H)	\$150	\$300
4	APSB72	External Stabilizer Bar (56"W)	\$99	\$396
1	APDOL2472L	Double Lateral File w/Open Shelf Credenza, Left (24"Dx72"Wx22"H)	\$2,397	\$2,397
1	APDOL2472R	Double Lateral File w/Open Shelf Credenza, Right (24"Dx72"Wx22"H)	\$2,397	\$2,397
2	APH72SD	Hutch w/One Sliding Door (14"Dx72"Wx36"H)	\$1,350	\$2,700
2	APTKBD1972	Hutch Tackboard (1"Dx70"Wx19"H)	\$643	\$1,286
<b>Total</b>			<b>\$11,206</b>	

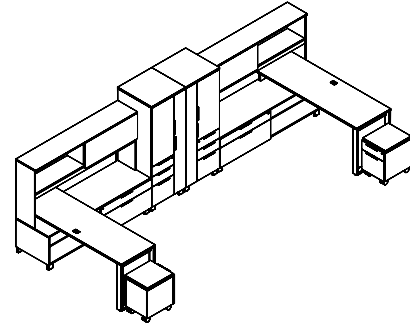

AP6				
Qty	Model #	Description	List price	Extended Price
2	APRT2472	Rectangular Top Worksurface (24"x72")	\$407	\$814
2	APODL24	D-Leg (16"Dx28"H)	\$458	\$916
2	APTLEG2406	Support T-Leg TFM (16"Dx13"Wx6"H)	\$150	\$300
4	APSB72	External Stabilizer Bar (56"W)	\$99	\$396
1	APSBL2472L	Single Box/Lateral Credenza, Left (24"Dx72"Wx22"H)	\$2,227	\$2,227
1	APSBL2472R	Single Box/Lateral Credenza, Right (24"Dx72"Wx22"H)	\$2,227	\$2,227
2	APH72SD	Hutch w/One Sliding Door (14"Dx72"Wx36"H)	\$1,350	\$2,700
2	APTKBD1972	Hutch Tackboard (1"Dx70"Wx19"H)	\$643	\$1,286
2	APPEDAX20 BF	Mobile Box/File Pedestal (19"Dx16"Wx22"H)	\$1,028	\$2,056
2	APCUH2016	Pedestal Cushion (19"Dx16"W)	\$271	\$542
1	APWCP2465R	Personal Wardrobe w/Storage Cabinet, Right (24"Dx24"Wx65"H)	\$2,037	\$2,037
1	APWCP2465L	Personal Wardrobe w/Storage Cabinet, Left (24"Dx24"Wx65"H)	\$2,037	\$2,037
<b>Total</b>			<b>\$17,538</b>	

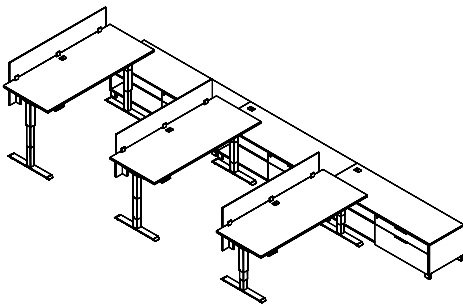

AP7R				
Qty	Model #	Description	List price	Extended Price
3	APRT3072	Rectangular Top Worksurface (30"Dx72"W)	\$455	\$1,365
3	MMLEGAHE30S	Adjustable Height Electrical Legs (24/30"Dx72"Wx23-48"H) Silver	\$1,407	\$4,221
3	APPSU72	Frosted Acrylic Privacy Screen (65"Wx12"Hx1"D)	\$694	\$2,082
3	APPSLHP72	HPL Modesty Panel (65"Wx12"H)	\$292	\$876
3	APSBL2472R	Single Box/Lateral Credenza, Right (24"Dx72"Wx22"H)	\$2,227	\$6,681
<b>Total</b>			<b>\$15,225</b>	

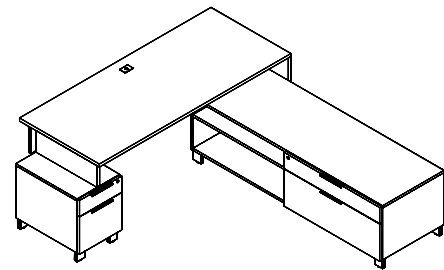

AP8R				
Qty	Model #	Description	List price	Extended Price
1	APRT3072	Rectangular Top Worksurface (30"Dx72"W)	\$455	\$455
1	APPED A24 BF	Supporting Box/File Pedestal (24"Dx16"Wx28"H)	\$1,232	\$1,232
1	APTLEG30	T-Leg (30"Dx12"Wx28"H)	\$177	\$177
1	APSB72	External Stabilizer Bar (65")	\$99	\$99
1	APPSLHP72	HPL Modesty Panel (65"Wx12"H)	\$292	\$292
1	APSBL2472R	Single Box/Lateral Credenza, Right (24"Dx72"Wx22"H)	\$2,227	\$2,227
<b>Total</b>			<b>\$4,482</b>	

# apex series

## Configurations

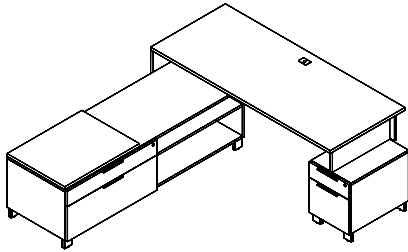

AP9L				
Qty	Model #	Description	List price	Extended Price
1	APRT3072	Rectangular Top Worksurface (30"Dx72"W)	\$455	\$455
1	APPEDA24BF	Supporting Box/File Pedestal (24"Dx16"Wx28"H)	\$1,232	\$1,232
1	APTLEG30	T-Leg (30"Dx12"Wx28"H)	\$177	\$177
1	APSB72	External Stabilizer Bar (65"W)	\$99	\$99
1	APPSLHP72	HPL Modesty Panel (65"Wx12"H)	\$292	\$292
1	APSBL2472L	Single Box/Lateral Credenza, Left (24"Dx72"Wx22"H)	\$2,227	\$2,227
1	APCUH2430	Credenza Cushion (23"Dx30"W)	\$328	\$328
<b>Total</b>			<b>\$4,810</b>	<b>\$4,810</b>

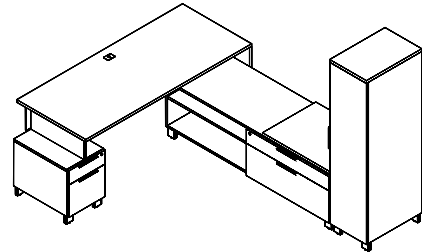

AP10R				
Qty	Model #	Description	List price	Extended Price
1	APRT3072	Rectangular Top Worksurface (30"Dx72"W)	\$455	\$455
1	APPEDA24BF	Supporting Box/File Pedestal (24"Dx16"Wx28"H)	\$1,232	\$1,232
1	APTLEG30	T-Leg (30"Dx12"Wx28"H)	\$177	\$177
2	APSB72	External Stabilizer Bar (65"W)	\$99	\$198
1	APPSL72	Frosted Acrylic Modesty (65"Wx12"H)	\$694	\$694
1	APSBL2472R	Single Box/Lateral Credenza, Right (24"Dx72"Wx22"H)	\$2,227	\$2,227
1	APCUH2430	Credenza Cushion (23"Dx30"W)	\$328	\$328
1	APSTS2465R	Single Storage Cabinet, Right (24"Dx16"Wx65"H)	\$1,802	\$1,802
<b>Total</b>			<b>\$7,113</b>	<b>\$7,113</b>

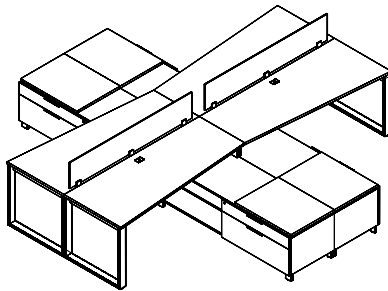

AP11				
Qty	Model #	Description	List price	Extended Price
2	APWT2472 30L	Wedge Top Worksurface (30/24"Dx72"W)	\$474	\$948
2	APWT2472 30R	Wedge Top Worksurface (24/30"Dx72"W)	\$474	\$948
4	APODL30	D-Leg (30"Dx28"H)	\$485	\$1,940
4	APTLEG3006	Support T-Leg (22"Dx13"Wx6"H)	\$158	\$632
8	APSB72	External Stabilizer Bar (65"W)	\$99	\$792
2	APPSU72	Frosted Acrylic Privacy Screen (65"Wx12"H)	\$694	\$1,388
2	APSBL2472R	Single Box/Lateral Credenza, Right (24"Dx72"Wx22"H)	\$2,227	\$4,454
2	APSBL2472L	Single Box/Lateral Credenza, Left (24"Dx72"Wx22"H)	\$2,227	\$4,454
4	APCUH2430	Credenza Cushion (23"Dx30"W)	\$328	\$1,312
<b>Total</b>			<b>\$16,868</b>	<b>\$16,868</b>

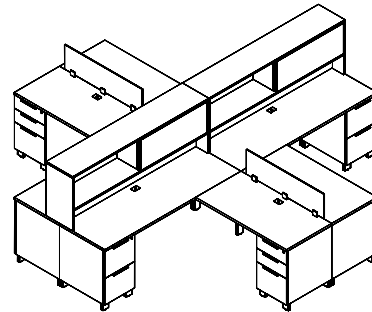

AP12				
Qty	Model #	Description	List price	Extended Price
4	APRT2472	Rectangular Top Worksurface (24"Dx72"W)	\$407	\$1,628
2	APHSB72	Two-sided Hutch, Shared Bins (14"Dx36"Hx72"W)	\$1,081	\$2,162
4	APRT2448	Rectangular Top Worksurface (24"Dx48"W)	\$274	\$1,096
2	APDPM24	Shared Double Post Leg (24"Dx28"H)	\$464	\$928
4	APPEDC24BBF	Supporting Box/Box/File Pedestal (24"Dx16"Wx28"H)	\$1,298	\$5,192
4	APPEDD24FF	Supporting File/File Pedestal (24"Dx16"Wx28"H)	\$1,243	\$4,972
4	APSB60	External Stabilizer Bar (44"W)	\$85	\$340
2	APPSU48	Frosted Acrylic Privacy Screen (41"Wx12"H)	\$472	\$944
4	APTKBD0872	Lower Tackboard (70"Wx8"H)	\$431	\$1,724
4	APTKBD1536	Upper Tackboard (35"Wx15"H)	\$393	\$1,572
4	APGANG1	Ganging Hardware (4"Dx6"Wx25"H)	\$43	\$172
<b>Total</b>			<b>\$20,730</b>	<b>\$20,730</b>

# apex series

## Configurations

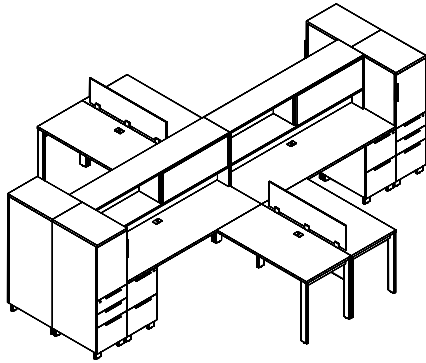

AP13				
Qty	Model #	Description	List price	Extended Price
4	APRT2472	Rectangular Top Worksurface (24"Dx72"W)	\$407	\$1,628
4	APRT2448	Rectangular Top Worksurface (24"Dx48"W)	\$274	\$1,096
4	APODPL24	Double Post Leg (24"Dx28"H)	\$373	\$1,492
2	APDPL24	Shared Double Post Leg (24"Dx28"H)	\$464	\$928
4	APPEDD24FF	Supporting File/File Pedestal (24"Dx16"Wx28"H)	\$1,243	\$4,972
4	APSB60	External Stabilizer Bar (44"W)	\$85	\$340
2	APPSU48	Frosted Acrylic Privacy Screen (41"Wx12"H)	\$472	\$944
2	APBCV2454L	Single Storage Box/Box/File Upper Door, Left (24"Dx16"Wx54"H)	\$2,037	\$4,074
2	APBCV2454R	Single Storage Box/Box/File Upper Door, Right (24"Dx16"Wx54"H)	\$2,037	\$4,074
2	APHSB72	Two-sided Hutch w/ Shared Bins (14"Dx72"Wx25"H)	\$1,081	\$2,162
4	APTKBD0872	Lower Tackboard (70"Wx8"H)	\$431	\$1,724
4	APTKBD1536	Upper Tackboard (35"Wx15"H)	\$393	\$1,572
4	APGANG1	Ganging Hardware (4"Dx6"Wx25"H)	\$43	\$172
<b>Total</b>			<b>\$25,178</b>	

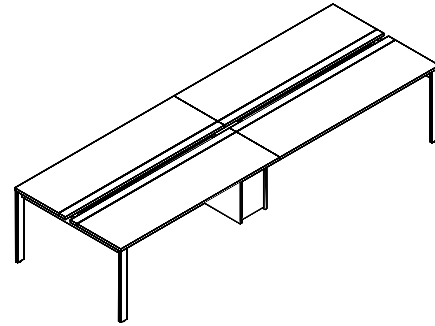

AP14				
Qty	Model #	Description	List price	Extended Price
2	APRECH4872	Shared Rectangular Top Worksurface (48"Dx72"W)	\$812	\$1,624
2	APODPL48	Double Post Leg (48"Dx28"H)	\$492	\$984
2	APWMT072	Outer Wire Management Trough (59"Wx8"Hx10"D)	\$956	\$1,912
4	APSB72	External Stabilizer Bar (56"W)	\$99	\$396
1	APLEGM1224	Square Panel Base Hollow, w/End Access Door (12"Dx24"W)	\$498	\$498
1	APESC72	Electrical Starter Cable (72")	\$226	\$226
4	APSSPB4	Single Sided Power Box w/4-Power Outlets	\$177	\$708
2	APDCE60	52" Daisy Chain Electrical Cable	\$226	\$452
1	APDCE72	64" Daisy Chain Electrical Cable	\$249	\$249
2	APGANG1	Ganging Hardware (4"Dx6"Wx25"H)	\$43	\$86
<b>Total</b>			<b>\$7,135</b>	

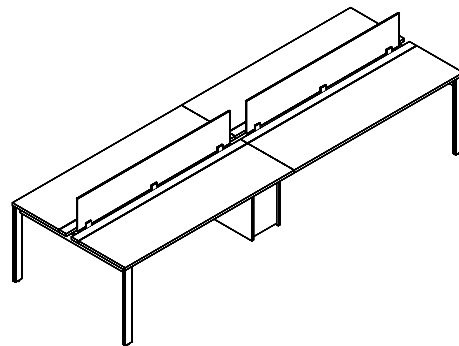

AP15				
Qty	Model #	Description	List price	Extended Price
2	APRECH4872	Rectangular (Shared) Worksurface (48"Dx72"W)	\$812	\$1,624
2	APODPL48	Double Post Leg (48"Dx28"H)	\$492	\$984
2	APWMT072	Outer Wire Management Trough (59"Wx8"Hx10"D)	\$956	\$1,912
4	APSB72	External Stabilizer Bar (56"W)	\$99	\$396
1	APLEGM1224	Square Panel Base Hollow, w/End Access Door (12"Dx24"W)	\$498	\$498
2	APPSU72	Frosted Acrylic Privacy Screen (65"Wx12"H)	\$694	\$1,388
1	APESC72	Electrical Starter Cable (72")	\$226	\$226
4	APSSPB4	Single Sided Power Box w/4-Power Outlets	\$177	\$708
2	APDCE60	52" Daisy Chain Electrical Cable	\$226	\$452
1	APDCE72	64" Daisy Chain Electrical Cable	\$249	\$249
2	APGANG1	Ganging Hardware (4"Dx6"Wx25"H)	\$43	\$86
<b>Total</b>			<b>\$8,523</b>	

# apex series

## Configurations

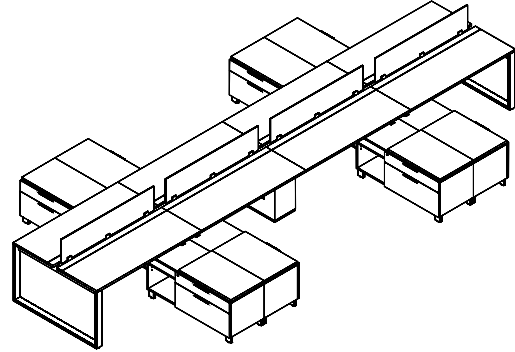
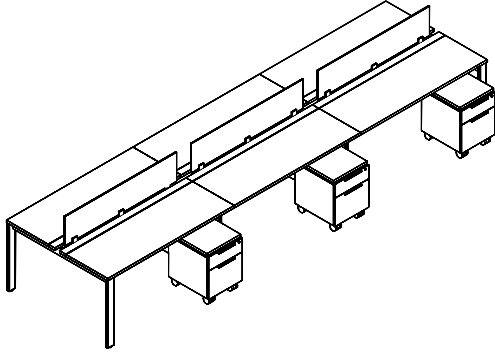

AP16				
Qty	Model #	Description	List price	Extended Price
3	APRECH4860	Rectangular (Shared) Worksurface (48"Dx60"W)	\$729	\$2,187
2	APODPL48	Double Post Leg (48"Dx28"H)	\$492	\$984
1	APWMTM60	Middle Wire Management Trough (48"Wx8"Hx10"D)	\$774	\$774
2	APWMT060	Outer Wire Management Trough (47"Wx8"Hx10"D)	\$759	\$1,518
6	APSB60	External Stabilizer Bar (44"W)	\$85	\$510
2	APLEGM1224	Square Panel Base Hollow, w/End Access Door (12"Dx24"W)	\$498	\$996
3	APPSU60	Frosted Acrylic Privacy Screen (53"Wx12"H)	\$682	\$2,046
6	APPEDAX20BF	Mobile Box/File Pedestal (19"Dx16"Wx22"H)	\$1,028	\$6,168
1	APESC72	Electrical Starter Cable (72")	\$226	\$226
6	APSSPB4	Single Sided Power Box w/4-Power Outlets	\$177	\$1,062
2	APDCE48	40" Daisy Chain Electrical Cable	\$203	\$406
3	APDCE60	52" Daisy Chain Electrical Cable	\$226	\$678
4	APGANG1	Ganging Hardware (4"Dx6"Wx25"H)	\$43	\$172
<b>Total</b>			<b>\$17,727</b>	

AP17				
Qty	Model #	Description	List price	Extended Price
4	APRECH4860	Rectangular (Shared) Worksurface (48"Dx60"W)	\$729	\$2,916
2	APODL48	D-Leg (48"Dx28"H)	\$570	\$1,140
2	APWMT060	Outer Wire Management Trough (47"Wx8"Hx10"D)	\$759	\$1,518
2	APWMTM60	Middle Wire Management Trough (48"Wx8"Hx10"D)	\$774	\$1,548
8	APSB60	External Stabilizer Bar (44"W)	\$85	\$680
3	APLEGM1224	Square Panel Base Hollow, w/End Access Door (12"Dx24"W)	\$498	\$1,494
4	APPSU60	Frosted Acrylic Privacy Screen (53"Wx12"H)	\$682	\$2,728
4	APSBL2048R	Single Box/Lateral Credenza, Right (20"Dx48"Wx22"H)	\$1,907	\$7,628
4	APSBL2048L	Single Box/Lateral Credenza, Left (20"Dx48"Wx22"H)	\$1,907	\$7,628
8	APCUH2030	Low Credenza Cushion (19"Dx30"Wx1"H)	\$308	\$2,464
1	APESC72	Electrical Starter Cable (72")	\$226	\$226
8	APSSPB4	Single Sided Power Box w/4-Power Outlets	\$177	\$1,416
2	APDCE48	40" Daisy Chain Electrical Cable	\$203	\$406
5	APDCE60	52" Daisy Chain Electrical Cable	\$226	\$1,130
6	APGANG1	Ganging Hardware (4"Dx6"Wx25"H)	\$43	\$258
<b>Total</b>			<b>\$33,180</b>	

# apex series

## Configurations

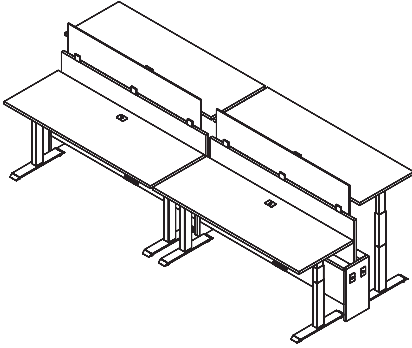

### AP18

Qty	Part Number	Part Description	List Price	Extended
4	APRT2465	Rectangular Top Worksurface, Silver Sq Grom Ctr (24"D x 65"W x 1")	\$389	\$1,556
4	MMLEGAHE24S	Silver Electrical Height Adjustable Base (For 24"D Top)	\$1,407	\$5,628
2	APWMT6636WDPS	Trough with Hinged Doors, Ctr Panel 36"H, Privacy Screen - APPSU66 (10"D x 66"W x 36"H)	\$1,794	\$3,588
1	APESC72	Electrical Starter Cable 72"W (8-Wire, 4-Circuit)	\$226	\$226
4	APSSPB4	Single Sided Power Box with 4 Power Outlets	\$177	\$708
2	APDCE66	58"W Daisy Chain Electrical Cable (For 66"W Trough)	\$242	\$484
1	APDCE60	46"W Daisy Chain Electrical Cable (For 54"W Trough)	\$226	\$226
			<b>Total</b>	<b>\$12,416</b>

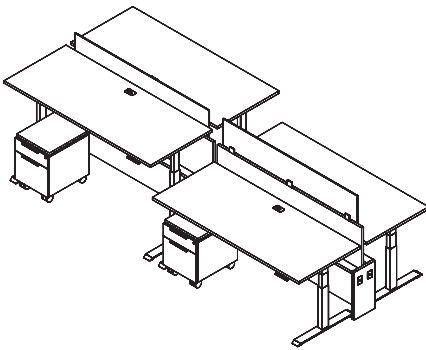

### AP19

Qty	Part Number	Part Description	List Price	Extended
4	APRT3071	Rectangular Top Worksurface (30"D x 71"W x 1")	\$455	\$1,820
4	MMLEGAHE30S	Silver Electrical Height Adjustable Base (For 30"D Top)	\$1,407	\$5,628
2	APWMT7236WDPS	Trough with Hinged Doors, Ctr Panel 36"H, Privacy Screen - APPSU72 (10"D x 72"W x 36"H)	\$1,837	\$3,674
4	APPEDAX20 BF	Mobile Box/ File Pedestal Face Lock, APH1 (20"D x 16"W x 22"H)	\$1,028	\$4,112
4	APCUH2016	Mobile Pedestal Cushion (19"D x 16"W x 1"H)	\$271	\$1,084
1	APESC72	Electrical Starter Cable 72"W (8-Wire, 4-Circuit)	\$226	\$226
1	APSSPB4	Single Sided Power Box with 4 Power Outlets	\$177	\$177
4	APDCE72	64"W Daisy Chain Electrical Cable (For 72"W Trough)	\$249	\$996
1	APDCE60	52"W Daisy Chain Electrical Cable (For 60"W Trough)	\$226	\$226
4	APRPG1S	Silver Rectangular Power Grommet (1 PWR, 2 USB) Ctr Top APRT3071	\$448	\$1,792
			<b>Total</b>	<b>\$19,735</b>

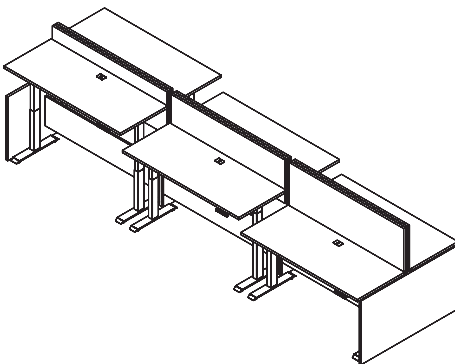

### AP20

Qty	Part Number	Part Description	List Price	Extended
6	APRT2459	Rectangular Top Worksurface, Silver Sq Grom Ctr (24"D x 59"W x 1")	\$363	\$2,178
6	MMLEGAHE24S	Silver Electrical Height Adjustable Base (For 24"D Top)	\$1,407	\$8,842
1	APWMT6048ND	Trough No Doors, Center End Panel 48"H (10"D x 66"W x 48"H)	\$876	\$876
2	APWMT6048ND48	Trough No Doors, Center End Panel 48"W and End Panel (10"D x 66"W x 48"H)	\$1,083	\$2,166
6	APTKBD1960	Tackboard (58"W x 19"H) For 60"W Trough	\$563	\$3,378
1	APESC72	Electrical Starter Cable 72"W (8-Wire, 4-Circuit)	\$226	\$226
6	APSSPB4	Single Sided Power Box with 4 Power Outlets	\$177	\$1,062
4	APDCE60	52"W Daisy Chain Electrical Cable (For 60"W Trough)	\$226	\$904
1	APDCE48	40"W Daisy Chain Electrical Cable (For 48"W Trough)	\$203	\$203
			<b>Total</b>	<b>\$19,835</b>

# apex series

## Configurations

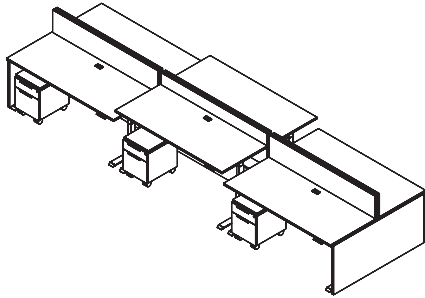

### AP21

Qty	Part Number	Part Description	List Price	Extended
6	APRT3071	Rectangular Top Worksurface, Silver Sq Grom Ctr (30"D x 71"W x 1")	\$455	\$2,730
6	MMLEGAHE30S	Silver Electrical Height Adjustable Base (For 30"D Top)	\$1,407	\$8,442
1	APWMT7242ND	Trough No Doors with Center Panel 48"H (10"D x 72"W x 42"H)	\$922	\$922
2	APWMT7242ND60	Trough No Doors with Center Panel 42"H & 60"W End Panel (10"D x 72"W x 42"H)	\$1,169	\$2,338
6	APTKBD1972	Tackboard (70"W x 19"H) For 72"W Trough	\$612	\$3,672
6	APPEDAX20 BF	Mobile Box/File Pedestal Face Lock, APH1 Handles (20"D x 16"W x 22"H)	\$1,028	\$6,168
6	APCUH2016	Mobile Pedestal Cushion (19"D x 16"W x 1"H)	\$271	\$1,626
1	APESC72	Electrical Starter Cable 72"W (8-Wire, 4-Circuit)	\$226	\$226
6	APSSPB4	Single Sided Power Box with 4 Power Outlets	\$177	\$1,062
4	APDCE72	64"W Daisy Chain Electrical Cable	\$249	\$996
1	APDCE60	52"W Daisy Chain Electrical Cable	\$226	\$226
6	APRPG1S	Silver Rectangular Power Grommet (1 PWR, 2 USB) Ctr Top APRT 3071	\$448	\$2,688
<b>Total</b>			<b>\$31,096</b>	

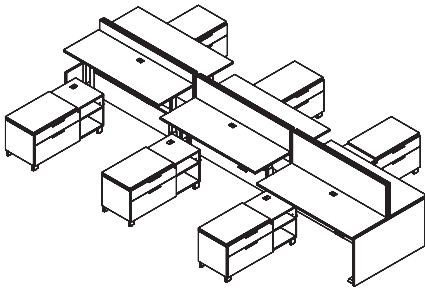

### AP22

Qty	Part Number	Part Description	List Price	Extended
6	APRT2465	Rectangular Top Worksurface, Silver Sq Grom Ctr (24"D x 65"W x 1")	\$389	\$2,334
6	MMLEGAHE24S	Silver Electrical Height Adjustable Base (For 24"D Top)	\$1,407	\$8,442
1	APWMT6648WD	Trough with Hinged Doors, Ctr Panel 48"H (10"D x 66"W x 48"H)	\$1,210	\$1,210
2	APWMT6648WD48	Trough with Hinged Doors, Ctr Panel 48"H & 48"W End Panel (10"D x 66"W x 48"H)	\$1,418	\$2,836
6	APTKBD1966	Tackboard (64"W x 19"H) for 66"W Trough	\$603	\$3,618
3	APSL2048L	Single Box/ Lateral Credenza, Left (20"D x 48"W x 22"H)	\$1,907	\$5,721
3	APSL2048R	Single Box/ Lateral Credenza, Right (20"D x 48"W x 22"H)	\$1,907	\$5,721
6	APCUH2030	Credenza Cushion (19"D x 30"W x 1 "H)	\$308	\$1,848
1	APESC72	Electrical Starter Cable 72"W (8-Wire, 4-Circuit)	\$226	\$226
6	APSSPB4	Single Sided Power Box with 4 Power Outlets	\$177	\$1,062
4	APDCE66	58"W Daisy Chain Electrical Cable (For 66"W Trough)	\$242	\$968
1	APDCE54	46"W Daisy Chain Electrical Cable (For 66"W Trough)	\$226	\$226
<b>Total</b>			<b>\$34,212</b>	

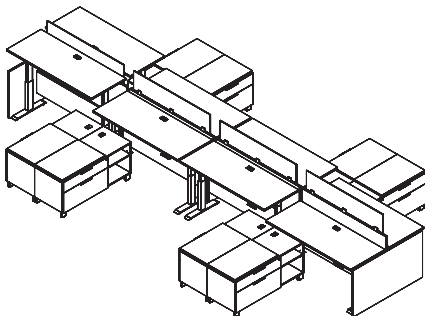

### AP23

Qty	Part Number	Part Description	List Price	Extended
8	APRT2459	Rectangular Top Worksurface, Silver Sq Grom Ctr (24"D x 59"W x 1")	\$363	\$2,904
8	MMLEGAHE24S	Silver Electrical Height Adjustable Base (For 24"D Top)	\$1,407	\$11,256
2	APWMT6036NDPS	Trough No Doors with Ctr Panel 36"H, Privacy Screen APPSU60 (10"D x 60"W x 36"H)	\$1,460	\$2,920
2	APWMT6036WD48PS	Trough No Doors with Ctr Panel 36"H & 48"W End Panel, Privacy Screen - APPSU60 (10"D x 60"W x 36"H)	\$1,957	\$3,914
4	APSL2048L	Single Box/ Lateral Credenza, Left (20"D x 48"W x 22"H)	\$1,907	\$7,628
4	APSL2048R	Single Box/ Lateral Credenza, Right (20"D x 48"W x 22"H)	\$1,907	\$7,628
8	APCUH2030	Credenza Cushion (19"D x 30"W x 1 "H)	\$308	\$2,464
1	APESC72	Cable 72"W (8-Wire, 4-Circuit)	\$226	\$226
8	APSSPB4	Single Sided Power Box with 4 Power Outlets	\$177	\$1,416
6	APDCE66	52"W Daisy Chain Electrical Cable (For 60"W Trough)	\$242	\$1,452
1	APDCE48	40"W Daisy Chain Electrical Cable (For 48"W Trough)	\$203	\$203
8	APRPG1S	Silver Rectangular Power Grommet (1 PWR, 2 USB) Ctr top APRT 2459	\$448	\$3,584
<b>Total</b>			<b>\$45,595</b>	

# apex series

## Worksurfaces

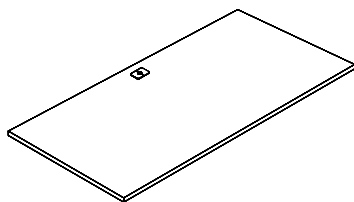

### Rectangular Worksurface

Model#	Depth	Width	Height	Weight	Cube	Price
APRT2030	20"	30"	1"	16	1	\$223
APRT2031	20"	31"	1"	17	1	\$223
APRT2036	20"	36"	1"	19	1	\$231
APRT2042	20"	42"	1"	22	1	\$241
APRT2048	20"	48"	1"	25	1	\$259
APRT2054	20"	54"	1"	29	1	\$305
* APRT2060	20"	60"	1"	32	1	\$340
APRT2062	20"	62"	1"	33	1	\$347
* APRT2066	20"	66"	1"	35	1	\$379
* APRT2072	20"	72"	1"	38	1	\$389
APRT2430	24"	30"	1"	19	1	\$236
APRT2431	24"	31"	1"	20	1	\$236
15 APRT2436	24"	36"	1"	23	1	\$244
15 APRT2442	24"	42"	1"	27	1	\$263
15 APRT2448	24"	48"	1"	30	1	\$274
15 APRT2454	24"	54"	1"	34	1	\$347
15 * APRT2460	24"	60"	1"	38	1	\$363
APRT2462	24"	62"	1"	39	1	\$367
15 * APRT2466	24"	66"	1"	42	1	\$389
15 * APRT2472	24"	72"	1"	45	1	\$407
APRT3048	30"	48"	1"	38	1	\$301
APRT3054	30"	54"	1"	43	1	\$389
15 * APRT3060	30"	60"	1"	47	2	\$399
* APRT3066	30"	66"	1"	52	2	\$432
15 * APRT3072	30"	72"	1"	57	2	\$455
* APRT3660	36"	60"	1"	57	2	\$437
* APRT3666	36"	66"	1"	62	2	\$472
* APRT3672	36"	72"	1"	68	2	\$494

1 silver square grommet (top center) standard.  
 Grommet on 20", 24" & 30"D is 3" clear from approach. On 36"D is 9" clear from approach.  
 Depending on support configuration, external stabilizer may be required on tops of 54" or greater.  
 See external stabilizer bar selection guide on p. 186.

\* 2 stabilizer bars are required on 60", 66" & 72" wide worksurfaces when supporting with left & right Double post leg, D-legs or T-legs

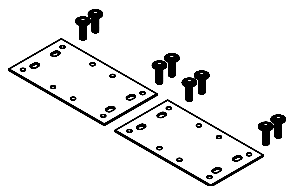

### Connecting Hardware (Brackets & Screws)

Model#	Depth	Width	Height	Weight	Cube	Price
15 APGANG1	4"	6"	.25"	2	1	\$43
15 APGANG2	4"	6"	.25"	3	1	\$85

NOTE: Must be field installed

\* If using as a return top, specify APGANG1 (2 brackets & 8 wood screws 8x1" supplied)

\* If using as a Bridge Top, specify APGANG2 (4 brackets & 16 wood screws 8x1" supplied)



# apex series

## Worksurfaces

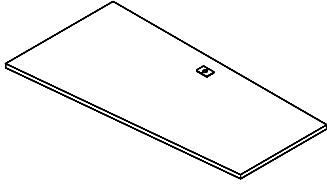

### Wedge Worksurface, Left

Model#	(L)	(B)	(E)	(W)	Weight	Cube	Price
* APWT206024L	60"	24"	20"	60"	38	1	\$385
* APWT206624L	66"	24"	20"	66"	42	1	\$413
* APWT207224L	72"	24"	20"	72"	45	1	\$432
15 * APWT246030L	60"	30"	24"	60"	47	2	\$420
* APWT246630L	66"	30"	24"	66"	52	2	\$448
15 * APWT247230L	72"	30"	24"	72"	57	2	\$474

1 silver square grommet (top center) standard. 3" clear from approach.  
 See external stabilizer bar selection guide on p. 186.  
 \* 2 stabilizer bars are required on 60", 66" & 72" wide worksurfaces when supporting with left & right Double post leg, D-legs or T-legs

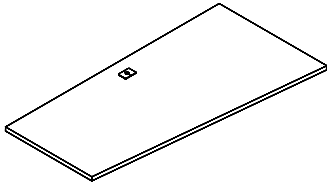

### Wedge Worksurface, Right

Model#	(L)	(B)	(E)	(W)	Weight	Cube	Price
* APWT206024R	60"	24"	20"	60"	38	1	\$385
* APWT206624R	66"	24"	20"	66"	42	1	\$413
* APWT207224R	72"	24"	20"	72"	45	1	\$432
15 * APWT246030R	60"	30"	24"	60"	47	2	\$420
* APWT246630R	66"	30"	24"	66"	52	2	\$448
15 * APWT247230R	72"	30"	24"	72"	57	2	\$474

1 silver square grommet (top center) standard. 3" clear from approach.  
 See external stabilizer bar selection guide on p. 186.  
 \* 2 stabilizer bars are required on 60", 66" & 72" wide worksurfaces when supporting with left & right Double post leg, D-legs or T-legs

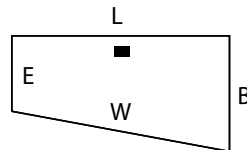

## Worksurfaces

### Extended Compu-Corner Worksurface, Left Return

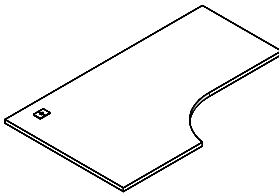

Model#	(L)	(B)	(E)	(K)	(R)	(W)	Weight	Cube	Price
* APET243660L	60"	36"	24"	21"	24"	22"	57	2	\$483
* APET243666L	66"	36"	24"	21"	24"	24"	62	2	\$512
* APET243672L	72"	36"	24"	21"	24"	30"	68	2	\$530
* APET244260L	60"	42"	24"	24"	24"	21"	66	2	\$516
* APET244266L	66"	42"	24"	24"	24"	27"	73	2	\$547
* APET244272L	72"	42"	24"	24"	24"	33"	79	2	\$564

1 silver square grommet (top corner) standard. 3" clear from approach.  
 See external stabilizer bar selection guide on p. 186.  
 \* 2 stabilizer bars are required on 60", 66" & 72" wide worksurfaces when supporting with left & right Double post leg, D-legs or T-legs

### Extended Compu-Corner Worksurface, Right Return

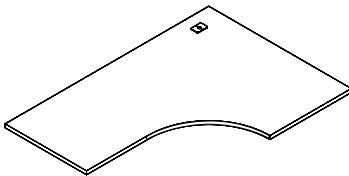

Model#	(L)	(B)	(E)	(K)	(R)	(W)	Weight	Cube	Price
* APET243660R	60"	36"	24"	21"	24"	22"	57	2	\$483
* APET243666R	66"	36"	24"	21"	24"	24"	62	2	\$512
* APET243672R	72"	36"	24"	21"	24"	30"	68	2	\$530
* APET244260R	60"	42"	24"	24"	24"	21"	66	2	\$516
* APET244266R	66"	42"	24"	24"	24"	27"	72	2	\$547
* APET244272R	72"	42"	24"	24"	24"	33"	79	2	\$564

1 silver square grommet (top corner) standard. 3" clear from approach.  
 See external stabilizer bar selection guide on p. 186.  
 \* 2 stabilizer bars are required on 60", 66" & 72" wide worksurfaces when supporting with left & right Double post leg, D-legs or T-legs

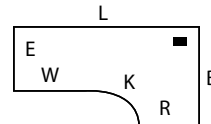

### Compu-Corner Angle Worksurface, Left

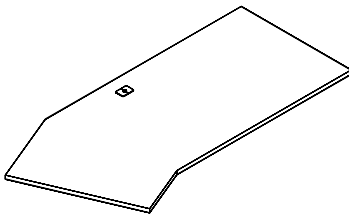

Model#	(L)	(B)	(E)	(K)	(W)	Weight	Cube	Price
APAT2472L	72"	24"	20"	48"	15"	59	2	\$578
APAT3072L	72"	30"	20"	48"	15"	68	2	\$620

1 silver square grommet (top center) standard. 3" clear from approach.  
 See external stabilizer bar selection guide on p. 186.  
 \* 2 stabilizer bars are required when supporting with left & right Double post leg, D-legs or T-legs

### Compu-Corner Angle Worksurface, Right

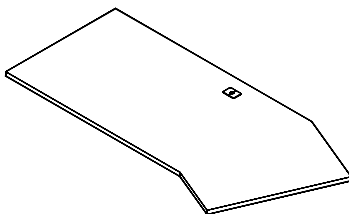

Model#	(L)	(B)	(E)	(K)	(W)	Weight	Cube	Price
APAT2472R	72"	24"	20"	48"	15"	59	2	\$578
APAT3072R	72"	30"	20"	48"	15"	68	2	\$620

1 silver square grommet (top center) standard. 3" clear from approach.  
 See external stabilizer bar selection guide on p. 186.  
 \* 2 stabilizer bars are required when supporting with left & right Double post leg, D-legs or T-legs

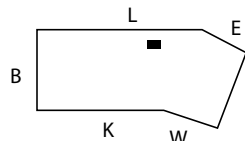

## Worksurfaces

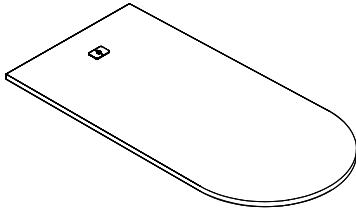

### Bullet Worksurface, Left

Model#	Depth	Width	Height	Weight	Cube	Price
<sup>15</sup> * APBD3060L	30"	60"	1"	47	2	\$483
* APBD3066L	30"	66"	1"	52	2	\$510
<sup>15</sup> * APBD3072L	30"	72"	1"	57	2	\$530
* APBD3672L	36"	72"	1"	68	2	\$571

1 left silver square grommet (top center) standard. 3" clear from approach.  
 See external stabilizer bar selection guide on p. 186.  
 \* 2 stabilizer bars are required on 60", 66" & 72" wide worksurfaces when supporting with left & right Double post leg, D-legs or T-legs

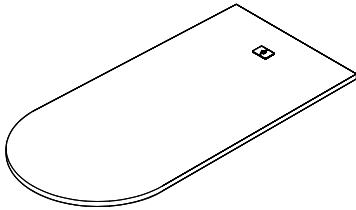

### Bullet Worksurface, Right

Model#	Depth	Width	Height	Weight	Cube	Price
<sup>15</sup> * APBD3060R	30"	60"	1"	47	2	\$483
* APBD3066R	30"	66"	1"	52	2	\$510
<sup>15</sup> * APBD3072R	30"	72"	1"	57	2	\$530
* APBD3672R	36"	72"	1"	68	2	\$571

1 right silver square grommet (top center) standard. 3" clear from approach.  
 See external stabilizer bar selection guide on p. 186.  
 \* 2 stabilizer bars are required on 60", 66" & 72" wide worksurfaces when supporting with left & right Double post leg, D-legs or T-legs

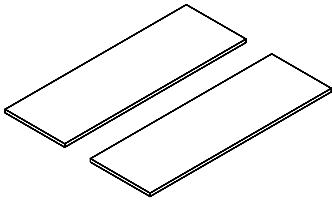

### Two Rectangular Worksurfaces for Shared Supports

Model#	Depth	Width	Height	Weight	Cube	Price
APRECH4848	48"	48"	1"	50	2	\$550
<sup>15</sup> APRECH4860	48"	60"	1"	63	2	\$729
APRECH4866	48"	66"	1"	69	2	\$778
<sup>15</sup> APRECH4872	48"	72"	1"	75	2	\$812
APRECH6048	60"	48"	1"	65	2	\$603
APRECH6060	60"	60"	1"	82	3	\$799
APRECH6066	60"	66"	1"	90	3	\$867
APRECH6072	60"	72"	1"	98	3	\$908

\* To be used with middle troughs, see p. 201. 2 stabilizers are required on tops of 54" or greater.  
 See external stabilizer bar selection guide on p. 186.

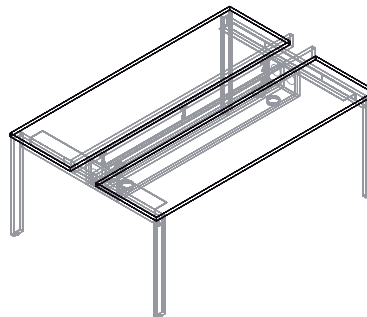

## Worksurfaces

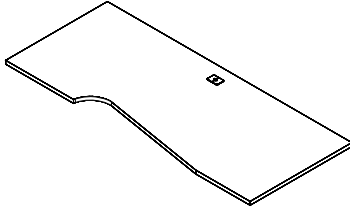

### Compu-Corner Saddle Worksurface, Left Return

Model#	(L)	(B)	(K)	(R)	(W)	Weight	Cube	Price
APST247220L	72"	24"	36"	20"	16"	45	1	\$544
APST247224L	72"	24"	32"	24"	16"	45	1	\$550
APST307220L	72"	30"	36"	20"	16"	57	2	\$578
APST307224L	72"	30"	32"	24"	16"	57	2	\$612

1 silver square grommet (top center) standard. 3" clear from approach.  
 See external stabilizer bar selection guide on p. 186.  
 \* 2 stabilizer bars are required on 60", 66" & 72" wide worksurfaces when supporting with left & right Double post leg, D-legs or T-legs

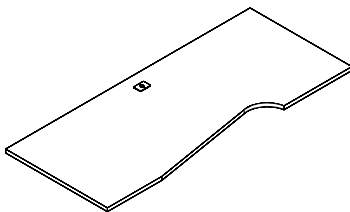

### Compu-Corner Saddle Worksurface, Right Return

Model#	(L)	(B)	(K)	(R)	(W)	Weight	Cube	Price
APST247220R	72"	24"	36"	20"	16"	45	1	\$544
APST247224R	72"	24"	32"	24"	16"	45	1	\$550
APST307220R	72"	30"	36"	20"	16"	57	2	\$578
APST307224R	72"	30"	32"	24"	16"	57	2	\$612

1 silver square grommet (top center) standard. 3" clear from approach.  
 See external stabilizer bar selection guide on p. 186.  
 \* 2 stabilizer bars are required on 60", 66" & 72" wide worksurfaces when supporting with left & right Double post leg, D-legs or T-legs

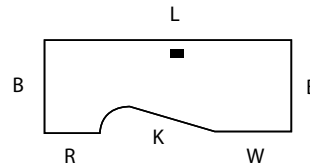

## Worksurfaces for Support Pedestals

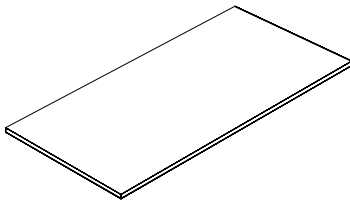

### Rectangular Worksurface, Tops for Supporting Pedestals

Model#	Depth	Width	Height	Fits Pedestal	Weight	Cube	Price
APT0P2016	20"	16"	1"	BBF, FF	9	1	\$151
APT0P2416	24"	16"	1"	BBF, FF	9	1	\$151
APT0P3016	30"	16"	1"	BBF, FF	13	1	\$151
APT0P2030	20"	30"	1"	HDC	16	1	\$223
APT0P2031	20"	31"	1"	LF, PLF	17	1	\$223
APT0P2430	24"	30"	1"	HDC	16	1	\$236
APT0P2431	24"	31"	1"	LF, PLF	20	1	\$244
15 APT0P2036	20"	36"	1"	LF, HDC	19	1	\$231
15 APT0P2436	24"	36"	1"	LF, HDC	23	1	\$244
APT0P2062	20"	62"	1"	2-LF, 2-PLF	33	1	\$347
APT0P2462	24"	62"	1"	2-LF, 2-PLF	39	1	\$367
15 APT0P2072	20"	72"	1"	2-LF, 2-HDC	45	1	\$389
15 APT0P2472	24"	72"	1"	2-LF, 2-HDC	45	1	\$407

\* Tops ship separately for field install, brackets are included. Tops only can be purchase for own use.

# apex series

## Worksurfaces and Privacy Panels

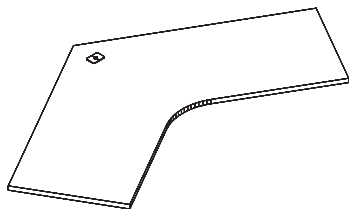

### Corner Worksurface, Silver Square Grommet

Model#	Depth	Width	Height	Weight	Cube	Price
APCCU424224	24"/24"	42x42"	1"	84	2	\$773
APCCU424230	30"/30"	42x42"	1"	94	2	\$819
APCCU484824	24"/24"	48x48"	1"	104	3	\$853
APCCU484830	30"/30"	48x48"	1"	115	3	\$899
APCCU545424	24"/24"	54x54"	1"	125	3	\$934
APCCU545430	30"/30"	54x54"	1"	137	3	\$981

Corner silver square grommet standard.

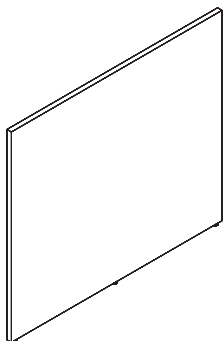

### Privacy Panel

Model#	Depth	Width	Height	Weight	Cube	Price
APPANEL4236	1"	42"	36"	42	1	\$513
APPANEL4836	1"	48"	36"	48	1	\$536
APPANEL5436	1"	54"	36"	54	2	\$553
APPANEL4242	1"	42"	42"	49	2	\$536
APPANEL4842	1"	48"	42"	56	2	\$566
APPANEL5442	1"	54"	42"	63	2	\$588
APPANEL4248	1"	42"	48"	56	2	\$566
APPANEL4848	1"	48"	48"	64	2	\$594
APPANEL5448	1"	54"	48"	72	2	\$623

No predrill holes. Ships separately for field install, brackets are included.  
Use for corner and other worksurfaces.

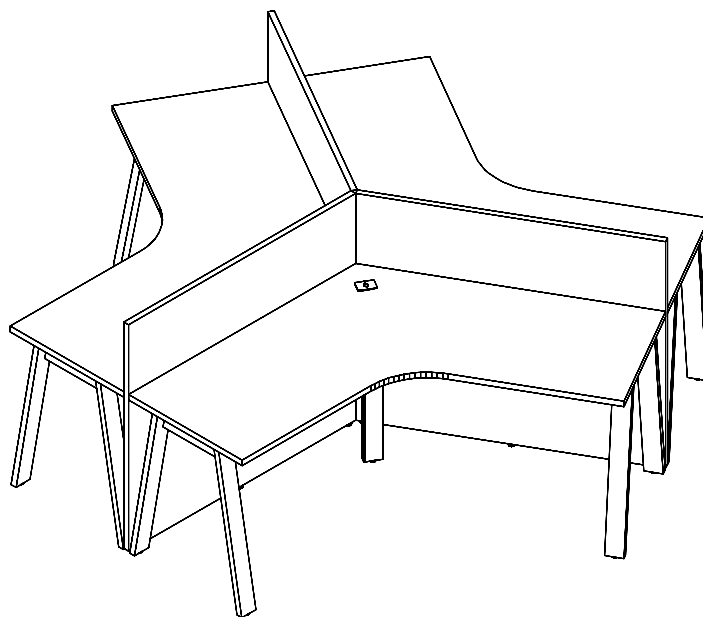

# apex series

## Support Pedestals

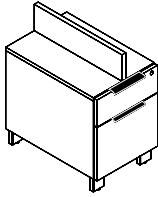

### Supporting Box/File with Top Center Support (Face lock, APH1 handles)

Model#	Depth	Width	Height	Weight	Cube	Price
APPEDA20BF	20"	16"	28"	73	6	\$1,205
APPEDA24BF	24"	16"	28"	78	7	\$1,232
APPEDA30BF	30"	16"	28"	89	8	\$1,264

Top support to be installed flush with tops.  
For flush pedestal with top specify location, add MMCUT3...\$179.

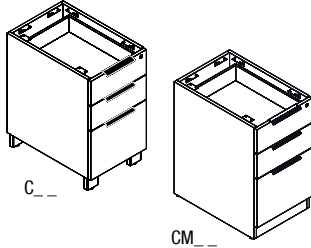

### Supporting Box/Box/File, No Top (Face lock, APH1 handles)

Model#	Depth	Width	Height	Weight	Cube	Price
15 APPEDC20BBF	20"	16"	28"	77	6	\$1,289
15 APPEDC24BBF	24"	16"	28"	83	7	\$1,298
APPEDC30BBF	30"	16"	28"	92	8	\$1,331
15 APPEDCM20BBF	20"	16"	28"	77	6	\$846
15 APPEDCM24BBF	24"	16"	28"	83	7	\$872
APPEDCM30BBF	30"	16"	28"	92	8	\$911

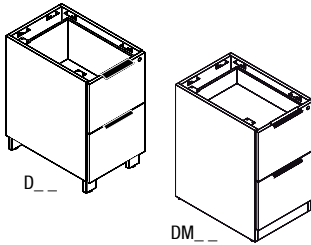

### Supporting File/File, No Top (Face lock, APH1 handles)

Model#	Depth	Width	Height	Weight	Cube	Price
15 APPEDD20FF	20"	16"	28"	73	6	\$1,219
15 APPEDD24FF	24"	16"	28"	79	7	\$1,243
APPEDD30FF	30"	16"	28"	88	8	\$1,278
15 APPEDDM20FF	20"	16"	28"	73	6	\$819
15 APPEDDM24FF	24"	16"	28"	79	7	\$846
APPEDDM30FF	30"	16"	28"	88	8	\$884

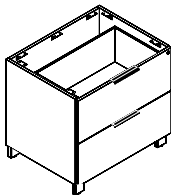

### Supporting Lateral File, No Top (Face lock, APH1 handles)

Model#	Depth	Width	Height	Weight	Cube	Price
APPEDLF2031	20"	31"	28"	111	11	\$1,501
15 APPEDLF2036	20"	36"	28"	120	12	\$1,533
APPEDLF2431	24"	31"	28"	118	13	\$1,546
15 APPEDLF2436	24"	36"	28"	128	14	\$1,579

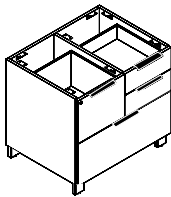

### Supporting Personal Lateral File, No Top (Face lock, APH1 handles)

Model#	Depth	Width	Height	Weight	Cube	Price
APPEDPLF2031	20"	31"	28"	124	11	\$1,639
APPEDPLF2431	24"	31"	28"	132	13	\$1,678

Box drawers do not lock, (1) lock locks file and lateral file drawer.

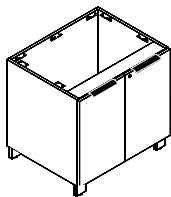

### Supporting Hinged Door Cabinet, No Top (Face lock, APH1 handles)

Model#	Depth	Width	Height	Weight	Cube	Price
APPEDHDC2030	20"	30"	28"	91	10	\$1,331
15 APPEDHDC2036	20"	36"	28"	104	12	\$1,343
APPEDHDC2430	24"	30"	28"	101	12	\$1,355
15 APPEDHDC2436	24"	36"	28"	115	14	\$1,376

1 adjustable 3/4" shelf is standard.

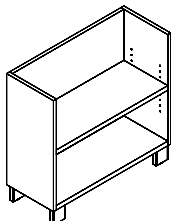

### Supporting Bookcase Pedestal 1-Adjustable Shelf, No Top

Model#	Depth	Width	Height	Weight	Cube	Price
APPEDBC24	12"	24"	28"	61	5	\$566
APPEDBC30	12"	30"	28"	61	6	\$588

1 adjustable 3/4" shelf is standard.

Pedestals with feet: silver is standard. For black feet upgrade, add APUFEETB, for white, add APUFEETW.

## Worksurface Supports

External Stabilizer Bar Specification Guide		Worksurface Width			
SUPPORT 1	SUPPORT 2	72"	66"	60"	54"
* A,D, DP-LEG	A,D, DP-LEG	* (2) APSB72	* (2) APSB66	* (2) APSB60	APSB54
* A,D, DP-LEG	T-LEG	* (2) APSB72	* (2) APSB66	* (2) APSB60	APSB54
A,D, DP-LEG	PEDESTAL (BBF or FF)	APSB60	APSB54	N/A	N/A
A,D, DP-LEG	LAT/PLF/HDC	N/A	N/A	N/A	N/A
T-LEG	T-LEG	APSB60	APSB54	N/A	N/A
T-LEG	PEDESTAL	APSB54	N/A	N/A	N/A
T-LEG	LAT/PLF/HDC	N/A	N/A	N/A	N/A
PEDESTAL	PEDESTAL	APSB54	N/A	N/A	N/A
PEDESTAL	LAT/PLF/HDC	N/A	N/A	N/A	N/A

\* NOTE: 2 stabilizer bars are required on 60", 66" & 72" wide worksurfaces when supported by left or right double post leg, D-legs or T-legs. If a modesty panel (TFM or HPL) is being specified only one stabilizer bar is required, acrylic modesty requires 2 stabilizer bars.

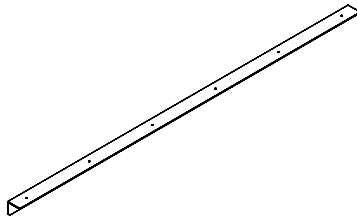

### External Stabilizer Bar

Model#	Depth	Width	Height	Top Width	Weight	Cube	Price
APSB54	2"	38"	2"	54"	5	1	\$78
APSB60	2"	44"	2"	60"	6	1	\$85
APSB66	2"	50"	2"	66"	7	1	\$92
APSB72	2"	56"	2"	72"	8	1	\$99

\* Reference stabilizer bar specification guide to determine stabilizer bar required. Stabilizer bars are recommended to be field installed 6" clear from approach side with #8 x 1" wood screws.

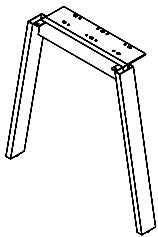

### Apron Frame Leg, Silver Finish (Specify black or white finish)

Model#	Depth	Width	Height	Top Depth	Weight	Cube	Price
APOAL20	20"	6"	28"	20"	15	3	\$390
APOAL24	24"	6"	28"	24"	22	3	\$413
APOAL30	30"	6"	28"	30" & 36"	26	4	\$435
APOAL48	48"	6"	28"	48"	40	6	\$578
APOAL60	60"	6"	28"	60"	46	7	\$610

Silver legs are standard. For black leg upgrade add APULEGB, for white leg add APULEGW. NOTE: 2 stabilizer bars are required on 60", 66" & 72" wide worksurfaces when supporting with left & right Apron Frame Leg. This leg style cannot be used for conference tables.

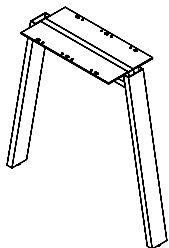

### Shared Apron Frame Leg, Silver Finish (Specify black or white finish)

Model#	Depth	Width	Height	Top Depth	Weight	Cube	Price
APMAL20	20"	6"	28"	20"	26	3	\$496
APMAL24	24"	6"	28"	24"	32	4	\$531
APMAL30	30"	6"	28"	30" & 36"	36	5	\$556

Silver legs are standard. For black leg upgrade add APULEGB, for white leg add APULEGW. NOTE: 2 stabilizer bars are required on 60", 66" & 72" wide worksurfaces when supporting with left & right Shared Apron Frame Leg. This leg style cannot be used for conference tables.



# apex series

## Worksurface Supports

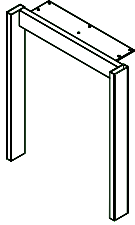

### Double Post Leg, Silver Finish (Specify black or white finish)

Model#	Depth	Width	Height	Top Depth	Weight	Cube	Price
APODPL20	20"	3"	28"	20"	15	3	\$348
<sup>15</sup> APODPL24	24"	3"	28"	24"	22	3	\$373
<sup>15</sup> APODPL30	30"	3"	28"	30" & 36"	26	4	\$399
<sup>15</sup> APODPL48	48"	3"	28"	48"	40	6	\$492
APODPL60	60"	3"	28"	60"	46	7	\$524

Silver legs are standard. For black leg upgrade add APULEGB, for white leg add APULEGW.  
NOTE: 2 stabilizer bars are required on 60", 66" & 72" wide worksurfaces when supporting with left & right Double post leg.

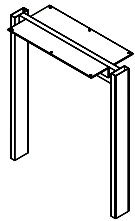

### Shared Double Post Leg, Silver Finish (Specify black or white finish)

Model#	Depth	Width	Height	Top Depth	Weight	Cube	Price
APDPML20	20"	3"	28"	20"	26	3	\$420
<sup>15</sup> APDPML24	24"	3"	28"	24"	32	4	\$464
<sup>15</sup> APDPML30	30"	3"	28"	30" & 36"	36	5	\$504

Silver legs are standard. For black leg upgrade add APULEGB, for white leg add APULEGW.  
\* Use to support 2 worksurfaces

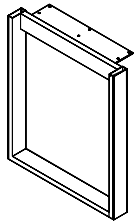

### D-Leg, Silver Finish (Specify black or white finish)

Model#	Depth	Width	Height	Top Depth	Weight	Cube	Price
APODL20	20"	3"	28"	20"	19	3	\$426
<sup>15</sup> APODL24	24"	3"	28"	24"	26	3	\$458
<sup>15</sup> APODL30	30"	3"	28"	30" & 36"	29	4	\$485
<sup>15</sup> APODL48	48"	3"	28"	48"	44	6	\$570
APODL60	60"	3"	28"	60"	50	7	\$628

Silver legs are standard. For black leg upgrade add APULEGB, for white leg add APULEGW.  
NOTE: 2 stabilizer bars are required on 60", 66" & 72" wide worksurfaces when supporting with left & right D-Leg.

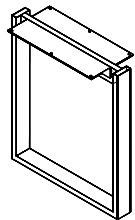

### Shared D-Leg, Silver Finish (Specify black or white finish)

Model#	Depth	Width	Height	Top Depth	Weight	Cube	Price
APMDL20	20"	3"	28"	20"	28	3	\$524
<sup>15</sup> APMDL24	24"	3"	28"	24"	37	4	\$544
<sup>15</sup> APMDL30	30"	3"	28"	30" & 36"	40	5	\$582

Silver legs are standard. For black leg upgrade add APULEGB, for white leg add APULEGW.  
\* Use to support 2 worksurfaces  
NOTE: 2 stabilizer bars are required on 60", 66" & 72" wide worksurfaces when supporting with left & right Shared D-Leg.

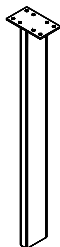

### Single Post, Silver Finish (Specify black or white finish)

Model#	Depth	Width	Height	Weight	Cube	Price
<sup>15</sup> APSPL28	1"	3"	28"	6	1	\$151

Silver legs are standard. For black leg upgrade add APULEGB, for white leg add APULEGW.  
Field install with #8 x 1" wood screws. Use for bullet tops or additional support under top.

## Worksurface Supports

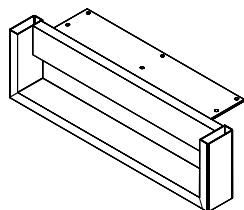

Short D-Leg, Silver Finish (Specify black or white finish)

Model#	Depth	Width	Height	Weight	Cube	Price
APOSDL20	20"	3"	6"	14	1	\$458
APOSDL24	24"	3"	6"	17	1	\$472
APOSDL30	30"	3"	6"	20	1	\$511

Silver legs are standard. For black leg upgrade add APULEGB, for white leg add APULEGW.  
 \* Supports worksurface below tops and above low credenza.  
 Cannot be used when specifying modesty below worksurface.  
 NOTE: 2 stabilizer bars are required on 60", 66" & 72" wide worksurfaces when supporting with left & right Short D-Leg.

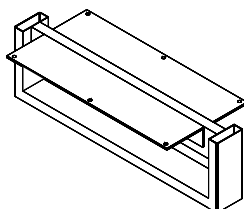

Short D-Leg Shared, Silver Finish (Specify black or white finish)

Model#	Depth	Width	Height	Weight	Cube	Price
APMSDL20	20"	3"	6"	23	1	\$436
APMSDL24	24"	3"	6"	26	1	\$458
APMSDL30	30"	3"	6"	29	1	\$504

Silver legs are standard. For black leg upgrade add APULEGB, for white leg add APULEGW.  
 \* Use to support 2 worksurfaces above low credenzas.  
 Cannot be used when specifying modesty below worksurface.  
 NOTE: 2 stabilizer bars are required on 60", 66" & 72" wide worksurfaces when supporting with left & right Short D-Leg Shared.

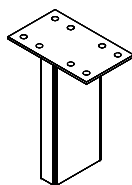

Low Post Leg, Silver Finish (Specify black or white finish)

Model#	Depth	Width	Height	Weight	Cube	Price
APSPL6	1"	3"	6"	5	1	\$66

Silver legs are standard. For black leg upgrade add APULEGB, for white leg add APULEGW.  
 \* Supports worksurface below tops and above low credenza.  
 Field install with #8 x 1" wood screws

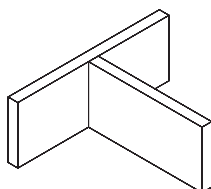

Support T-Leg, TFM (For low credenza)

Model#	Depth	Width	Height	Fits Top Depth	Weight	Cube	Price
APTLEG2006	12"	13"	6"	20"	3	1	\$144
APTLEG2406	16"	13"	6"	24"	4	1	\$150
APTLEG3006	22"	13"	6"	30"	5	1	\$158

Must be ordered when specifying modesty below worksurface.  
 Supports worksurface above low credenza, pin and cam connection to worksurface underside.

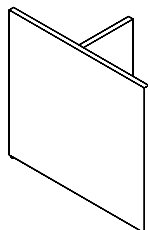

T-Leg (TFM leg)

Model#	Depth	Width	Height	Weight	Cube	Price
APTLEG20	20"	13"	28"	26	5	\$157
APTLEG24	24"	13"	28"	27	6	\$170
APTLEG30	30"	13"	28"	31	7	\$177

NOTE: 2 stabilizer bars are required on 60", 66" & 72" wide worksurfaces when supporting with left & right T-leg.

# apex series

## Worksurface Supports, Bases

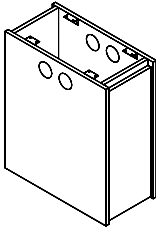

### Square Panel Base (Hollow with end access door)

Model#	Depth	Width	Height	Weight	Cube	Price
APLEGM1224	12"	24"	28"	47	5	\$498
APLEGM1230	12"	30"	28"	56	6	\$609

4 grommet cutouts standard.  
To be used with shared worksurfaces and wire management troughs.

## Adjustable Bases

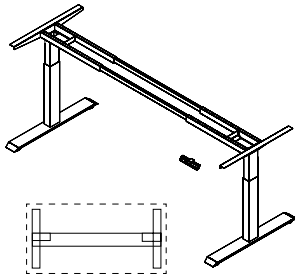

### Adjustable Height Electrical Base

Model#	Base(D)	Base (W)	Height	Fits Top Size	Color	Weight	Cube	Price
MMLEGAHE24S	22"	47-72"	23 1/2-49"	24"D-72"W	Silver	64	1	\$1,407
MMLEGAHE24B	22"	47-72"	23 1/2-49"	24"D-72"W	Black	64	1	\$1,407
MMLEGAHE24W	22"	47-72"	23 1/2-49"	24"D-72"W	White	64	1	\$1,407
MMLEGAHE30S	28"	47-72"	23 1/2-49"	30"D-72"W	Silver	64	1	\$1,407
MMLEGAHE30B	28"	47-72"	23 1/2-49"	30"D-72"W	Black	64	1	\$1,407
MMLEGAHE30W	28"	47-72"	23 1/2-49"	30"D-72"W	White	64	1	\$1,407

2 Stage base.  
Bases ship unassembled unless otherwise specified. For base functions see training section.

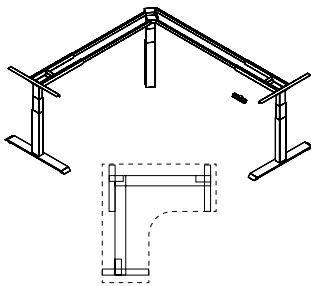

### Adjustable Height Electrical L-Unit Base (Sit to stand, fits top sizes below)

Model#	Base(D)	Base (W)	Height	Fits Top Size	Color	Weight	Cube	Price
MMLEGAHEL24B3	22"	48-72"	23 1/2-49"	24"D-72"W	Black	112	1	\$2,407
MMLEGAHEL24S3	22"	48-72"	23 1/2-49"	24"D-72"W	Silver	112	1	\$2,407
MMLEGAHEL24W3	22"	48-72"	23 1/2-49"	24"D-72"W	White	112	1	\$2,407
MMLEGAHEL30S3	28"	48-72"	23 1/2-49"	30"D-72"W	Silver	112	1	\$2,407
MMLEGAHEL30W3	28"	48-72"	23 1/2-49"	30"D-72"W	White	112	1	\$2,407
MMLEGAHEL30B3	28"	48-72"	23 1/2-49"	30"D-72"W	Black	112	1	\$2,407

3 Stage base.  
Bases ship unassembled unless otherwise specified. For base functions see training section.

# apex series

## Privacy Screens

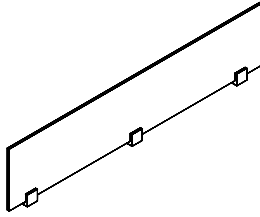

### Frosted Acrylic Privacy Screen (3/8" thick acrylic)

Model#	Depth	Width	Height	Weight	Cube	Price
APPSU24	1"	17"	12"	4	1	\$217
APPSU30	1"	23"	12"	6	1	\$269
APPSU36	1"	29"	12"	7	1	\$351
APPSU42	1"	35"	12"	8	1	\$385
15 APPSU48	1"	41"	12"	9	1	\$472
APPSU54	1"	47"	12"	10	1	\$676
15 APPSU60	1"	53"	12"	11	1	\$682
APPSU66	1"	59"	12"	12	1	\$688
15 APPSU72	1"	65"	12"	13	1	\$694

\* Privacy screens APPSU24 thru APPSU48 include 2 mounting clips.

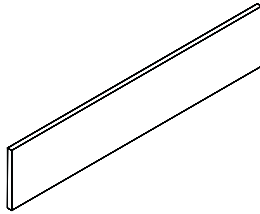

### TFM Privacy Screen (1" thick)

Model#	Depth	Width	Height	Weight	Cube	Price
APPSUW2412	1"	17"	12"	8	1	\$102
APPSUW3012	1"	23"	12"	10	1	\$102
APPSUW3612	1"	29"	12"	12	1	\$119
APPSUW4212	1"	35"	12"	14	1	\$119
APPSUW4812	1"	41"	12"	15	1	\$131
APPSUW5412	1"	47"	12"	17	1	\$131
15 APPSUW6012	1"	53"	12"	19	1	\$150
APPSUW6612	1"	59"	12"	21	1	\$159
15 APPSUW7212	1"	65"	12"	23	1	\$159

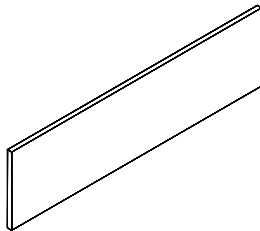

### TFM Privacy Screen (1" thick)

Model#	Depth	Width	Height	Weight	Cube	Price
APPSUW2415	1"	17"	15"	10	1	\$204
APPSUW3015	1"	23"	15"	12	1	\$204
APPSUW3615	1"	29"	15"	15	1	\$235
APPSUW4215	1"	35"	15"	17	1	\$235
APPSUW4815	1"	41"	15"	19	1	\$265
APPSUW5415	1"	47"	15"	22	1	\$265
15 APPSUW6015	1"	53"	15"	24	1	\$299
APPSUW6615	1"	59"	15"	26	1	\$320
15 APPSUW7215	1"	65"	15"	27	1	\$320

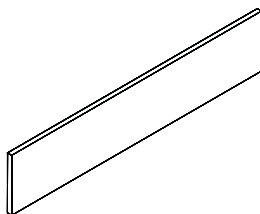

### HPL Privacy Screen (1" thick)

Model#	Depth	Width	Height	Weight	Cube	Price
APPSUHP2412	1"	17"	12"	8	1	\$150
APPSUHP3012	1"	23"	12"	10	1	\$150
APPSUHP3612	1"	29"	12"	12	1	\$181
APPSUHP4212	1"	35"	12"	14	1	\$181
APPSUHP4812	1"	41"	12"	15	1	\$221
APPSUHP5412	1"	47"	12"	17	1	\$221
APPSUHP6012	1"	53"	12"	19	1	\$268
APPSUHP6612	1"	59"	12"	21	1	\$292
APPSUHP7212	1"	65"	12"	23	1	\$292

## Privacy Screens

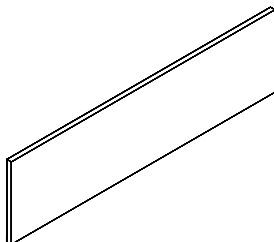

HPL Privacy Screen (1" thick)

Model#	Depth	Width	Height	Weight	Cube	Price
APPSUHP2415	1"	17"	15"	10	1	\$299
APPSUHP3015	1"	23"	15"	12	1	\$299
APPSUHP3615	1"	29"	15"	15	1	\$361
APPSUHP4215	1"	35"	15"	17	1	\$361
APPSUHP4815	1"	41"	15"	19	1	\$439
APPSUHP5415	1"	47"	15"	22	1	\$439
APPSUHP6015	1"	53"	15"	24	1	\$534
APPSUHP6615	1"	59"	15"	26	1	\$581
APPSUHP7215	1"	65"	15"	29	1	\$581

Privacy screens location: Center (left to right) is standard on worksurfaces. For custom location, must be specified. Add MMCUT3...\$179 list.

## Privacy Screen Extensions

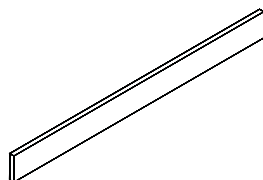

TFM Extension (1" thick) for Frosted Acrylic Privacy Screens

Model#	Depth	Width	Height	Weight	Cube	Price
APPSUW2406	1"	17"	6"	3	1	\$102
APPSUW3006	1"	23"	6"	4	1	\$102
APPSUW3606	1"	29"	6"	5	1	\$119
APPSUW4206	1"	35"	6"	6	1	\$119
APPSUW4806	1"	41"	6"	7	1	\$131
APPSUW5406	1"	47"	6"	8	1	\$131
APPSUW6006	1"	53"	6"	9	1	\$150
APPSUW6606	1"	59"	6"	10	1	\$159
APPSUW7206	1"	65"	6"	11	1	\$159

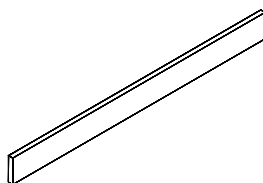

HPL Extension (1" thick) for Frosted Acrylic Privacy Screens

Model#	Depth	Width	Height	Weight	Cube	Price
APPSUHP2406	1"	17"	6"	3	1	\$150
APPSUHP3006	1"	23"	6"	4	1	\$150
APPSUHP3606	1"	29"	6"	5	1	\$181
APPSUHP4206	1"	35"	6"	6	1	\$181
APPSUHP4806	1"	41"	6"	7	1	\$221
APPSUHP5406	1"	47"	6"	8	1	\$221
APPSUHP6006	1"	53"	6"	9	1	\$268
APPSUHP6606	1"	59"	6"	10	1	\$292
APPSUHP7206	1"	65"	6"	11	1	\$292

# apex series

## Modesty Panels

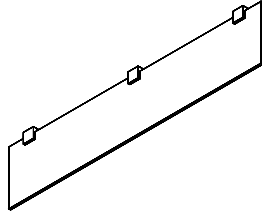

### Frosted Acrylic Modesty (3/8" thick acrylic)

Model#	Depth	Width	Height	Weight	Cube	Price
APPSL24	1"	17"	12"	4	1	\$217
APPSL30	1"	23"	12"	6	1	\$269
APPSL36	1"	29"	12"	7	1	\$351
APPSL42	1"	35"	12"	8	1	\$385
APPSL48	1"	41"	12"	9	2	\$472
APPSL54	1"	47"	12"	10	2	\$676
APPSL60	1"	53"	12"	11	2	\$682
APPSL66	1"	59"	12"	12	2	\$688
APPSL72	1"	65"	12"	13	2	\$694

\* Modesties APPSL24 thru APPSL48 include 2 mounting clips.

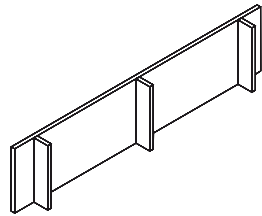

### TFM Modesty (3/4" thick)

Model#	Depth	Width	Height	Weight	Cube	Price
APPSLW24	4"	17"	12"	7	1	\$102
APPSLW30	4"	23"	12"	8	1	\$102
APPSLW36	4"	29"	12"	10	1	\$119
APPSLW42	4"	35"	12"	11	1	\$119
APPSLW48	4"	41"	12"	13	2	\$131
APPSLW54	4"	47"	12"	15	2	\$131
APPSLW60	4"	53"	12"	16	2	\$150
APPSLW66	4"	59"	12"	18	2	\$159
APPSLW72	4"	65"	12"	19	2	\$159

\* 3/4" thick TFM. Modesties APPSLW24 thru APPSLW48 include 2 vertical supports.

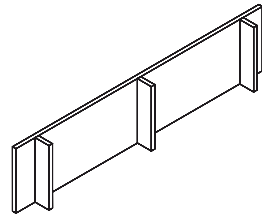

### HPL Modesty (3/4" thick)

Model#	Depth	Width	Height	Weight	Cube	Price
APPSLHP24	4"	17"	12"	7	1	\$150
APPSLHP30	4"	23"	12"	8	1	\$150
APPSLHP36	4"	29"	12"	10	1	\$181
APPSLHP42	4"	35"	12"	11	1	\$181
APPSLHP48	4"	41"	12"	13	2	\$221
APPSLHP54	4"	47"	12"	15	2	\$221
APPSLHP60	4"	53"	12"	16	2	\$268
APPSLHP66	4"	59"	12"	18	2	\$292
APPSLHP72	4"	65"	12"	19	2	\$292

\* 3/4" thick HPL. Modesties APPSLHP24 thru APPSLHP48 include 2 vertical supports.

#### Modesty Panel Standard Location:

Center left to right and flush to approach side is standard under worksurfaces, except 36"D tops, inset is 6".

For custom location, must be specified. Add MMCUT3...\$179 ea.

# apex series

## Low Credenzas

### Left Open Credenza, Silver Feet, 2-Adjustable shelves, 4 Grommets (Specify black or white feet)

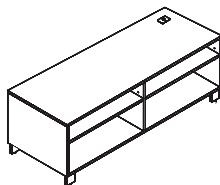

Model#	Depth	Width	Height	Weight	Cube	Price
APDO2048L	20"	48"	22"	115	13	\$1,429
APDO2060L	20"	60"	22"	136	16	\$1,670
APDO2066L	20"	66"	22"	146	17	\$1,683
APDO2072L	20"	72"	22"	156	19	\$1,730
APDO2448L	24"	48"	22"	132	15	\$1,506
APDO2460L	24"	60"	22"	156	19	\$1,730
APDO2466L	24"	66"	22"	167	21	\$1,768
APDO2472L	24"	72"	22"	179	22	\$1,821

Silver feet are standard. For black feet upgrade add APUFEETB, for white feet add APUFEETW.  
\* Standard right silver square grommet on top, modesty, adjustable shelf and bottom shelf.

### Right Open Credenza, Silver Feet, 2-Adjustable Shelves, 4 Grommets (Specify black or white feet)

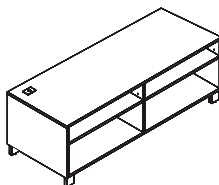

Model#	Depth	Width	Height	Weight	Cube	Price
APDO2048R	20"	48"	22"	115	13	\$1,429
APDO2060R	20"	60"	22"	136	16	\$1,670
APDO2066R	20"	66"	22"	147	17	\$1,683
APDO2072R	20"	72"	22"	156	19	\$1,730
APDO2448R	24"	48"	22"	132	15	\$1,506
APDO2460R	24"	60"	22"	156	19	\$1,730
APDO2466R	24"	66"	22"	167	21	\$1,768
APDO2472R	24"	72"	22"	179	22	\$1,821

Silver feet are standard. For black feet upgrade add APUFEETB, for white feet add APUFEETW.  
\* Standard left silver square grommet on top, modesty, adjustable shelf and bottom shelf.

### Left Single Box/Lateral Credenza, Silver Feet, Locking, 1-Adjustable shelf, 4 Grommets (Specify black or white feet)

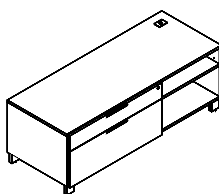

Model#	Depth	Width	Height	Weight	Cube	Price
APSBL2048L	20"	48"	22"	147	13	\$1,907
15 APSBL2060L	20"	60"	22"	165	16	\$1,991
APSBL2066L	20"	66"	22"	173	17	\$2,032
15 APSBL2072L	20"	72"	22"	182	19	\$2,070
APSBL2448L	24"	48"	22"	161	15	\$1,978
15 APSBL2460L	24"	60"	22"	181	19	\$2,097
APSBL2466L	24"	66"	22"	191	21	\$2,162
15 APSBL2472L	24"	72"	22"	201	22	\$2,227

Silver feet are standard. For black feet upgrade add APUFEETB, for white feet add APUFEETW.  
\* Standard right silver square grommet on top, modesty, adjustable shelf and bottom shelf.  
31"W Box/Lateral file on 48"W credenzas only.

### Right Single Box/Lateral Credenza, Silver Feet, Locking, 1-Adjustable Shelf, 4 Grommets (Specify black or white feet)

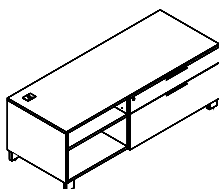

Model#	Depth	Width	Height	Weight	Cube	Price
APSBL2048R	20"	48"	22"	147	13	\$1,907
15 APSBL2060R	20"	60"	22"	165	16	\$1,991
APSBL2066R	20"	66"	22"	173	17	\$2,032
15 APSBL2072R	20"	72"	22"	182	19	\$2,070
APSBL2448R	24"	48"	22"	161	15	\$1,978
15 APSBL2460R	24"	60"	22"	181	19	\$2,097
APSBL2466R	24"	66"	22"	191	21	\$2,162
15 APSBL2472R	24"	72"	22"	201	22	\$2,227

Silver feet are standard. For black feet upgrade add APUFEETB, for white feet add APUFEETW.  
\* Standard left silver square grommet on top, modesty, adjustable shelf and bottom shelf.  
31"W Box/Lateral file on 48"W credenzas only.



# apex series

## Low Credenzas

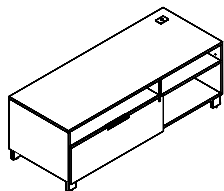

**Left Single Lateral Credenza,**  
Silver Feet, Locking, 1-Adjustable Shelf, 4 Grommets (Specify black or white feet)

Model#	Depth	Width	Height	Weight	Cube	Price
APSL02048L	20"	48"	22"	142	13	\$1,802
APSL02060L	20"	60"	22"	163	16	\$2,010
APSL02066L	20"	66"	22"	173	17	\$2,050
APSL02072L	20"	72"	22"	183	19	\$2,097
APSL02448L	24"	48"	22"	159	15	\$1,867
APSL02460L	24"	60"	22"	184	19	\$2,097
APSL02466L	24"	66"	22"	195	21	\$2,149
APSL02472L	24"	72"	22"	207	22	\$2,194

Silver feet are standard. For black feet upgrade add APUFEETB, for white feet add APUFEETW.  
\* Standard left silver square grommet on top, modesty, adjustable shelf and bottom shelf.  
31"W Box/Lateral file on 48"W credenzas only.

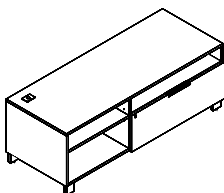

**Right Single Lateral Credenza,**  
Silver Feet, Locking, 1-Adjustable Shelf, 4 Grommets (Specify black or white feet)

Model#	Depth	Width	Height	Weight	Cube	Price
APSL02048R	20"	48"	22"	142	13	\$1,802
APSL02060R	20"	60"	22"	163	16	\$2,010
APSL02066R	20"	66"	22"	173	17	\$2,050
APSL02072R	20"	72"	22"	183	19	\$2,097
APSL02448R	24"	48"	22"	159	15	\$1,867
APSL02460R	24"	60"	22"	184	19	\$2,097
APSL02466R	24"	66"	22"	195	21	\$2,149
APSL02472R	24"	72"	22"	207	22	\$2,194

Silver feet are standard. For black feet upgrade add APUFEETB, for white feet add APUFEETW.  
\* Standard left silver square grommet on top, modesty, adjustable shelf and bottom shelf.  
31"W Box/Lateral file on 48"W credenzas only.

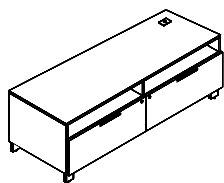

**Left Double Lateral Credenza, Silver Feet, Locking, 2 Grommets (Specify black or white feet)**

Model#	Depth	Width	Height	Weight	Cube	Price
APDOL2061L	20"	61"	22"	196	16	\$2,227
APDOL2072L	20"	72"	22"	219	19	\$2,293
APDOL2461L	24"	61"	22"	218	19	\$2,351
APDOL2472L	24"	72"	22"	244	22	\$2,397

Silver feet are standard. For black feet upgrade add APUFEETB, for white feet add APUFEETW.  
\* Standard right silver square grommet on top & modesty.

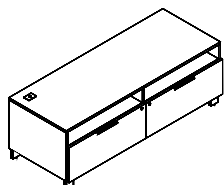

**Right Double Lateral Credenza, Silver Feet, Locking, 2 Grommets (Specify black or white feet)**

Model#	Depth	Width	Height	Weight	Cube	Price
APDOL2061R	20"	61"	22"	196	16	\$2,227
APDOL2072R	20"	72"	22"	219	19	\$2,293
APDOL2461R	24"	61"	22"	218	19	\$2,351
APDOL2472R	24"	72"	22"	244	22	\$2,397

Silver feet are standard. For black feet upgrade add APUFEETB, for white feet add APUFEETW.  
\* Standard left silver square grommet on top & modesty.

# apex series

## Freestanding Storage

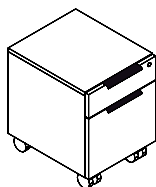

### Mobile Pedestal (Box/File, Locking)

Model#	Depth	Width	Height	Weight	Cube	Price
APPEDAX20BF	20"	16"	22"	73	5	\$1,028
APPEDAX24BF	24"	16"	22"	78	7	\$1,054

\* Seating weight capacity 175lbs.

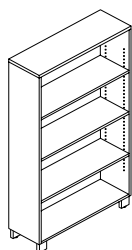

### Bookcase, Silver Feet (Specify black or white feet)

Model#	Depth	Width	Height	# of Shelves	Weight	Cube	Price
APBC30	12"	36"	29"	1	66	8	\$724
APBC54	12"	36"	54"	2	107	14	\$926
APBC65	12"	36"	65"	3	137	17	\$1,089

Silver feet are standard. For black feet upgrade add APUFEETB, for white feet add APUFEETW. Adjustable shelves are 3/4" thick, recommended weight is 20 lbs each, distributed evenly.

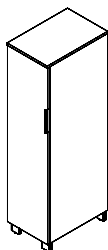

### Left Single Storage Cabinet, Silver Feet (Specify black or white feet)

Model#	Depth	Width	Height	# of Shelves	Weight	Cube	Price
APSTS2054L	20"	16"	54"	2	112	10	\$1,617
APSTS2065L	20"	16"	65"	3	135	13	\$1,704
APSTS2454L	24"	16"	54"	2	126	12	\$1,697
APSTS2465L	24"	16"	65"	3	151	15	\$1,802

Silver feet are standard. For black feet upgrade add APUFEETB, for white feet add APUFEETW. Optional lock available, add MMFL...\$90. Adjustable shelves are 3/4" thick.

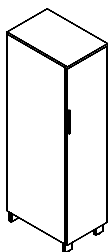

### Right Single Storage Cabinet, Silver Feet (Specify black or white feet)

Model#	Depth	Width	Height	# of Shelves	Weight	Cube	Price
APSTS2054R	20"	16"	54"	2	112	10	\$1,617
APSTS2065R	20"	16"	65"	3	135	13	\$1,704
APSTS2454R	24"	16"	54"	2	126	12	\$1,697
APSTS2465R	24"	16"	65"	3	151	15	\$1,802

Silver feet are standard. For black feet upgrade add APUFEETB, for white feet add APUFEETW. Optional lock available, add MMFL...\$90. Adjustable shelves are 3/4" thick.

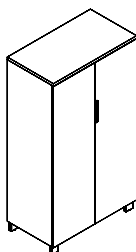

### Double Storage Cabinet, Silver Feet (Specify black or white feet)

Model#	Depth	Width	Height	# of Shelves	Weight	Cube	Price
APDST2054	20"	36"	54"	2	188	23	\$1,966
APDST2065	20"	36"	65"	3	228	28	\$2,129
APDST2454	24"	36"	54"	2	209	27	\$2,050
APDST2465	24"	36"	65"	3	253	33	\$2,215

Silver feet are standard. For black feet upgrade add APUFEETB, for white feet add APUFEETW. Optional lock available, add MMFL...\$90. Adjustable shelves are 3/4" thick.

## Freestanding Storage

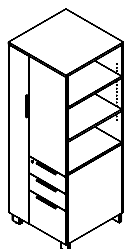

**Left Personal Bookcase Storage Cabinet,**  
Silver Feet, Box/Box/File, Locking (Specify black or white feet)

Model#	Depth	Width	Height	# of Shelves	Weight	Cube	Price
APPBSC2054L	20"	24"	54"	3	178	15	\$1,887
APPBSC2065L	20"	24"	65"	5	208	19	\$1,959
APPBSC2454L	24"	24"	54"	3	198	18	\$1,913
APPBSC2465L	24"	24"	65"	5	229	22	\$1,998

Silver feet are standard. For black feet upgrade add APUFEETB, for white feet add APUFEETW.  
\* No coat rack. 2 Adjustable shelves on long compartment on 54"H, and 3-adjustable shelves on 65"H.  
Optional face lock for hinged door available, add MMFL...\$90. Adjustable shelves are 3/4" thick.

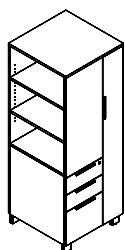

**Right Personal Bookcase Storage Cabinet,**  
Silver Feet, Box/Box/File, Locking (Specify black or white feet)

Model#	Depth	Width	Height	# of Shelves	Weight	Cube	Price
APPBSC2054R	20"	24"	54"	3	178	15	\$1,887
APPBSC2065R	20"	24"	65"	5	208	19	\$1,959
APPBSC2454R	24"	24"	54"	3	198	18	\$1,913
APPBSC2465R	24"	24"	65"	5	229	22	\$1,998

Silver feet are standard. For black feet upgrade add APUFEETB, for white feet add APUFEETW.  
\* No coat rack. 2 Adjustable shelves on long compartment on 54"H, and 3-adjustable shelves on 65"H.  
Optional face lock for hinged door available, add MMFL...\$90. Adjustable shelves are 3/4" thick.

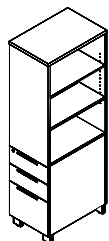

**Left Single Personal Bookcase Cabinet,**  
Silver Feet, Box/Box/File, Locking (Specify black or white feet)

Model#	Depth	Width	Height	# of Shelves	Weight	Cube	Price
APBCPS2054L	20"	16"	54"	1	126	10	\$1,774
APBCPS2065L	20"	16"	65"	2	143	13	\$1,829
APBCPS2454L	24"	16"	54"	1	137	12	\$1,867
APBCPS2465L	24"	16"	65"	2	157	15	\$1,925

Silver feet are standard. For black feet upgrade add APUFEETB, for white feet add APUFEETW.  
Adjustable shelves are 3/4" thick.

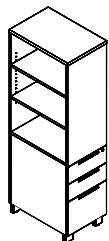

**Right Single Personal Bookcase Cabinet,**  
Silver Feet, Box/Box/File, Locking (Specify black or white feet)

Model#	Depth	Width	Height	# of Shelves	Weight	Cube	Price
APBCPS2054R	20"	16"	54"	1	126	10	\$1,774
APBCPS2065R	20"	16"	65"	2	143	13	\$1,829
APBCPS2454R	24"	16"	54"	1	137	12	\$1,867
APBCPS2465R	24"	16"	65"	2	157	15	\$1,925

Silver feet are standard. For black feet upgrade add APUFEETB, for white feet add APUFEETW.  
Adjustable shelves are 3/4" thick.

# apex series

## Freestanding Storage

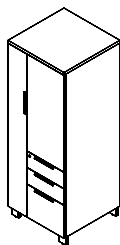

**Left Personal Wardrobe Cabinet,**  
Silver Feet, Box/Box/File, Locking (Specify black or white Feet)

Model#	Depth	Width	Height	# of Shelves	Weight	Cube	Price
APWCP2454L	24"	24"	54"	1	208	18	\$1,945
APWCP2465L	24"	24"	65"	2	239	22	\$2,037

Silver feet are standard. For black feet upgrade add APUFEETB, for white feet add APUFEETW.  
\* Coat rack bar in long compartment included. Adjustable shelves are 3/4" thick.  
Optional face lock for hinged door available (two required), add MMFL...\$90/ea.

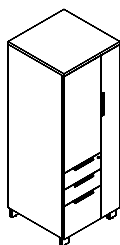

**Right Personal Wardrobe Cabinet,**  
Silver Feet, Box/Box/File, Locking (Specify black or white Feet)

Model#	Depth	Width	Height	# of Shelves	Weight	Cube	Price
APWCP2454R	24"	24"	54"	1	208	18	\$1,945
APWCP2465R	24"	24"	65"	2	239	22	\$2,037

Silver feet are standard. For black feet upgrade add APUFEETB, for white feet add APUFEETW.  
\* Coat rack bar in long compartment included. Adjustable shelves are 3/4" thick.  
Optional face lock for hinged door available (2 required), add MMFL...\$90/ea.

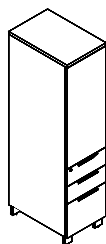

**Left Single Storage Cabinet,**  
Silver Feet, Box/Box/File, Locking (Specify black or white Feet)

Model#	Depth	Width	Height	# of Shelves	Weight	Cube	Price
APBCV2054L	20"	16"	54"	1	136	10	\$1,953
APBCV2065L	20"	16"	65"	2	153	13	\$2,032
APBCV2454L	24"	16"	54"	1	147	12	\$2,037
APBCV2465L	24"	16"	65"	2	167	15	\$2,097

Silver feet are standard. For black feet upgrade add APUFEETB, for white feet add APUFEETW.  
Optional face lock for hinged door available, add MMFL...\$90. Adjustable shelves are 3/4" thick.



**Right Single Storage Cabinet,**  
Silver Feet, Box/Box/File, Locking (Specify black or white Feet)

Model#	Depth	Width	Height	# of Shelves	Weight	Cube	Price
APBCV2054R	20"	16"	54"	1	136	10	\$1,953
APBCV2065R	20"	16"	65"	2	153	13	\$2,032
APBCV2454R	24"	16"	54"	1	147	12	\$2,037
APBCV2465R	24"	16"	65"	2	167	15	\$2,097

Silver feet are standard. For black feet upgrade add APUFEETB, for white feet add APUFEETW.  
Optional face lock for hinged door available, add MMFL...\$90. Adjustable shelves are 3/4" thick.

# apex series

## Overhead Storage

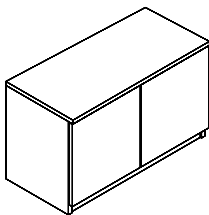
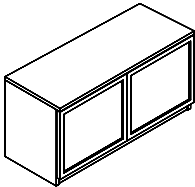
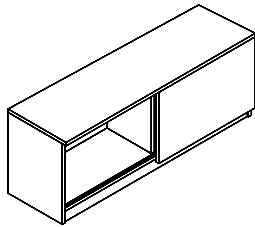
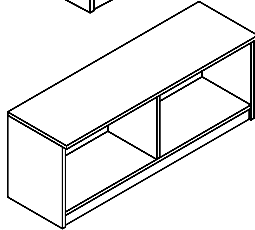
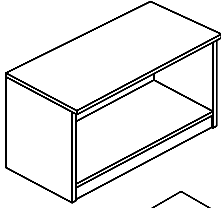

### Wall Mount Cabinet, No Doors, with Fascia

Model#	Depth	Width	Height	Weight	Cube	Price
APCFOH030	14 3/4"	30"	18 1/2"	47	5	\$623
APCFOH036	14 3/4"	36"	18 1/2"	53	6	\$740
APCFOH042	14 3/4"	42"	18 1/2"	63	7	\$858
APCFOH048	14 3/4"	48"	18 1/2"	69	8	\$911

Optional tasklight APTSKLTX24...add \$222. 42"W & 48"W cabinet has center divider.  
Requires professional installation and must be mounted to wall stud.  
35lb. weight capacity distributed evenly.

### Wall Mount Cabinet with One Sliding Door, with Fascia

Model#	Depth	Width	Height	Weight	Cube	Price
APCFOHS30	14 3/4"	30"	18 1/2"	58	5	\$864
APCFOHS36	14 3/4"	36"	18 1/2"	65	6	\$983
APCFOHS42	14 3/4"	42"	18 1/2"	71	7	\$1,102
APCFOHS48	14 3/4"	48"	18 1/2"	78	8	\$1,174

\* No lock available. Optional tasklight APTSKLTX24...add \$222.  
Requires professional installation and must be mounted to wall stud.  
35lb. weight capacity distributed evenly.

### Wall Mount Cabinet with Frosted Glass Doors, with Fascia

Model#	Depth	Width	Height	Weight	Cube	Price
APCFOHG36	14 3/4"	36"	18 1/2"	63	6	\$1,127

\* No lock available. Optional tasklight APTSKLTX24...add \$222.  
Requires professional installation and must be mounted to wall stud.  
35lb. weight capacity distributed evenly.

### Wall Mount Cabinet with Laminate Hinged Doors, with Fascia

Model#	Depth	Width	Height	# of Doors	Weight	Cube	Price
APCFOHD30	14 3/4"	30"	18 1/2"	2	58	5	\$911
APCFOHD36	14 3/4"	36"	18 1/2"	2	67	6	\$936
APCFOHD42	14 3/4"	42"	18 1/2"	2	79	7	\$1,075
APCFOHD48	14 3/4"	48"	18 1/2"	4	87	8	\$1,108

Optional tasklight APTSKLTX24...add \$222.  
Optional face lock available (two required for 42" & 48" wide) add MMFL...\$90 each.  
Requires professional installation and must be mounted to wall stud.  
35lb. weight capacity distributed evenly.

# apex series

## Hutches

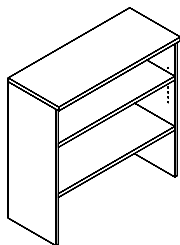

### Bookcase Hutch, 1-Fixed and 1-Adjustable Shelf

Model#	Depth	Width	Height	Weight	Cube	Price
APBCH36	14"	36"	36"	79	11	\$520

Bottom clearance 12"H.  
35lb. weight capacity distributed evenly.

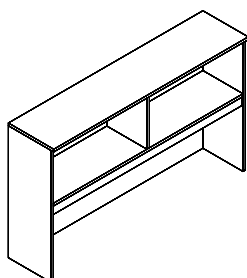

### Hutch, No Doors, with Fascia

Model#	Depth	Width	Height	Weight	Cube	Price
APH36ND	14"	36"	36"	71	11	\$688
APH42ND	14"	42"	36"	84	13	\$766
APH48ND	14"	48"	36"	92	14	\$846
APH54ND	14"	54"	36"	100	16	\$884
APH60ND	14"	60"	36"	109	18	\$924
APH66ND	14"	66"	36"	116	20	\$977
APH72ND	14"	72"	36"	125	21	\$1,028

Optional tasklight APTSKLTX24...add \$222.  
Bottom clearance 17 1/4" from fascia.  
35lb. weight capacity distributed evenly.

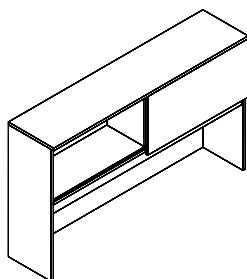

### Hutch with One Sliding Door, with Fascia

Model#	Depth	Width	Height	Weight	Cube	Price
APH36SD	14"	36"	36"	81	11	\$989
APH42SD	14"	42"	36"	92	13	\$1,061
APH48SD	14"	48"	36"	99	14	\$1,133
APH54SD	14"	54"	36"	108	16	\$1,205
APH60SD	14"	60"	36"	118	18	\$1,278
APH72SD	14"	72"	36"	136	21	\$1,350

\* No lock available. Optional tasklight APTSKLTX24...add \$222.  
Bottom clearance 17 1/4" from fascia.  
35lb. weight capacity distributed evenly.

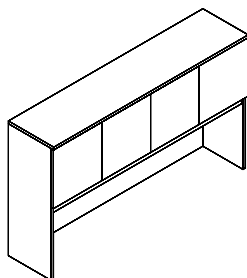

### Hutch with Laminate Hinged Doors, with Fascia

Model#	Depth	Width	Height	# of Doors	Weight	Cube	Price
APH36WD	14"	36"	36"	2	83	11	\$884
APH42WD	14"	42"	36"	2	98	13	\$996
APH48WD	14"	48"	36"	4	108	14	\$1,119
APH54WD	14"	54"	36"	4	118	16	\$1,174
APH60WD	14"	60"	36"	4	129	18	\$1,224
APH66WD	14"	66"	36"	4	139	20	\$1,300
APH72WD	14"	72"	36"	4	149	21	\$1,351

Optional tasklight APTSKLTX24...add \$222.  
Optional face locks (two locks are required for 42"W & 4 door hutches) MMFL...add \$90 each.  
Bottom clearance 17 1/4" from fascia.  
35lb. weight capacity distributed evenly.

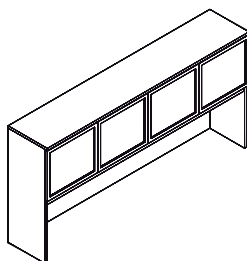

### Hutch with Frosted Glass Doors, with Fascia

Model#	Depth	Width	Height	# of Doors	Weight	Cube	Price
APH36WG	14"	36"	36"	2	82	11	\$1,133
APH72WG	14"	72"	36"	4	145	21	\$1,923

\* No lock available. Optional tasklight APTSKLTX24...add \$222.  
Bottom clearance 17 1/4" from fascia.  
35lb. weight capacity distributed evenly.

NOTE: If placing hutch on L-unit return, leg support is required, email our Design Department.

# apex series

## Hutches

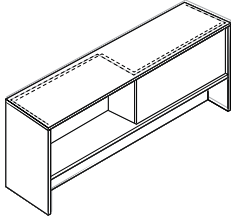

### Two-Sided Hutch with Open Shared Bins

Model#	Depth	Width	Height	Weight	Cube	Price
APHSB60	14"	60"	25"	84	13	\$1,002
APHSB66	14"	66"	25"	91	14	\$1,042
APHSB72	14"	72"	25"	97	15	\$1,081

Bottom clearance 9"H. Optional tackboards available for lower and upper section. 35lb. weight capacity distributed evenly.

## Tasklight

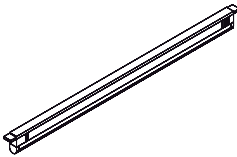

### Tasklight, Black (Additional option for hutch or wall mount cabinets)

Model#	Depth	Width	Height	Weight	Cube	Price
APTSCLTX24	7/8"	24 1/2"	1 7/8"	1	1	\$222

LED light. Inter connect to other lights, can link up to 6 units max. One grommet is included on hutch back panel.

## Tackboards

### Tackboard (For hutches with 36" height)

Model#	Depth	Width	Height	Hutch Width	Weight	Cube	Price
APTKBD1936	1/2"	34"	19"	36"	6	1	\$367
APTKBD1942	1/2"	40"	19"	42"	7	1	\$458
<sup>15</sup> APTKBD1948	1/2"	46"	19"	48"	8	1	\$485
APTKBD1954	1/2"	52"	19"	54"	9	1	\$498
<sup>15</sup> APTKBD1960	1/2"	58"	19"	60"	10	1	\$563
APTKBD1966	1/2"	64"	19"	66"	11	1	\$603
<sup>15</sup> APTKBD1972	1/2"	70"	19"	72"	12	1	\$643

For underground fabrics add 25%.

### Tackboard (Lower) for Two Sided Hutch

Model#	Depth	Width	Height	Hutch Width	Weight	Cube	Price
APTKBD0860	1/2"	58"	8"	60"	5	1	\$373
APTKBD0866	1/2"	64"	8"	66"	5	1	\$399
APTKBD0872	1/2"	70"	8"	72"	5	1	\$431

Fits APHSB hutch only. 2 lower tackboards required on 2 sided hutch. For underground fabrics add 25%.

### Tackboard (Upper) for Two Sided Hutch

Model#	Depth	Width	Height	Hutch Width	Weight	Cube	Price
APTKBD1530	1/2"	29"	15"	60"	4	1	\$348
APTKBD1533	1/2"	32"	15"	66"	5	1	\$367
APTKBD1536	1/2"	35"	15"	72"	5	1	\$393

Fits APHSB hutch only. 2 upper tackboards required on 2 sided hutch. For underground fabrics add 25%.

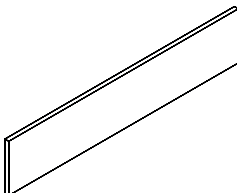
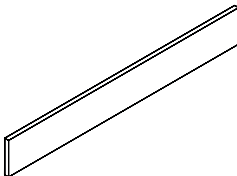
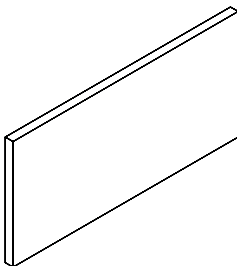



## Tackboards

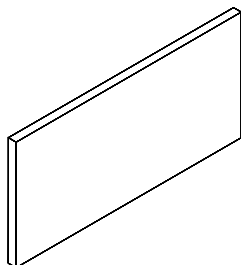

### Tackboard (For 15"H TFM privacy screens)

Model#	Depth	Width	Height	Weight	Cube	Price
APTKBD1029	1/2"	28"	10"	3	1	\$334
APTKBD1035	1/2"	34"	10"	4	1	\$353
APTKBD1041	1/2"	40"	10"	4	1	\$441
APTKBD1047	1/2"	46"	10"	5	1	\$467
APTKBD1053	1/2"	52"	10"	5	1	\$478
15 APTKBD1059	1/2"	58"	10"	6	1	\$542
15 APTKBD1065	1/2"	64"	10"	6	1	\$579

For underground fabrics add 25%.

## Cushions

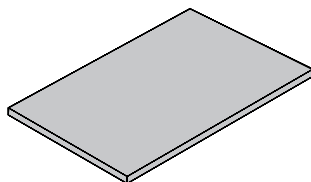

### Cushion (Standard fabrics)

Model#	Depth	Width	Height	Fits Pedestal Depth	Weight	Cube	Price
15 APCUH2016	19"	16"	1"	20"	4	1	\$271
15 APCUH2416	23"	16"	1"	24"	5	1	\$289
APCUH2030	19"	30"	1"	20"	7	1	\$308
APCUH2430	23"	30"	1"	24"	8	1	\$328
15 APCUH2036	19"	36"	1"	20"	8	1	\$340
15 APCUH2436	23"	36"	1"	24"	10	1	\$362

16"W for pedestal, 30"W & 36"W for credenza. Design to fit Apex pedestal only.  
For underground fabrics add 25%.

## Wire Management

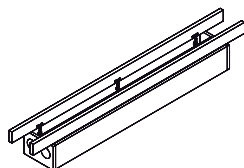

### Middle Wire Management Trough with Hinged Doors

Model#	Depth	Width	Height	Weight	Cube	Price
APWMTM48	10"	36"	8"	47	3	\$650
APWMTM60	10"	48"	8"	58	3	\$774
APWMTM66	10"	54"	8"	63	4	\$864
APWMTM72	10"	60"	8"	69	4	\$970

\* To be used between square panel bases. Grommet holes on left and right side.  
Designed to fit shared worksurfaces only.

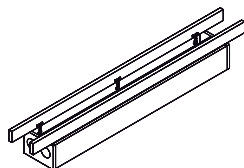

### Outer Wire Management Trough with Hinged Doors

Model#	Depth	Width	Height	Weight	Cube	Price
APWMT048	10"	35"	8"	47	3	\$635
15 APWMT060	10"	47"	8"	58	3	\$759
APWMT066	10"	53"	8"	63	4	\$851
15 APWMT072	10"	59"	8"	69	4	\$956

\* To be used between one metal support leg and one square panel base.  
Grommet holes one side only. Designed to fit shared worksurfaces only.

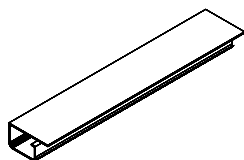

### Plastic Wire Management Trough, Black

Model#	Depth	Width	Height	Weight	Cube	Price
APPWM12	2"	12"	1"	1	1	\$24
APPWM18	2"	18"	1"	1	1	\$24

Color: Black only. Field installed below worksurface with #8 x 1" wood screws (supplied).

# apex series

## Data/Power Management

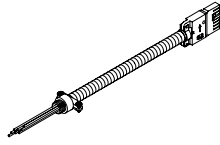

### Electrical Starter Cable (8-wire, 4-circuit)

Model#	Depth	Width	Height	Weight	Cube	Price
APESC72	1"	72"	1"	3	1	\$226

Must be connected to a building electrical supply by licensed electrician. (40) outlets maximum per single feed. (Available for freestanding trough)



### Daisy Chain Electrical Cable

Model#	Depth	Width	Height	Fits Trough	Weight	Cube	Price
APDCE24	1"	24"	1"		2	1	\$159
APDCE36	1"	28"	1"		2	1	\$183
APDCE48	1"	40"	1"	48"	2	1	\$203
APDCE54	1"	46"	1"		2	1	\$226
APDCE60	1"	52"	1"	54"	3	1	\$226
APDCE66	1"	58"	1"	66"	3	1	\$242
APDCE72	1"	64"	1"	72"	3	1	\$249

Daisy chain available for freestanding trough



### Split Cable (8-wire, 4-circuit)

Model#	Depth	Width	Height	Color	Weight	Cube	Price
APSFC12	1"	12"	1"	Metal	1	1	\$149

Used to split into two directions as a "Y" coupler.



### Single-Sided Power Box (4-Power outlets)

Model#	Depth	Width	Height	Weight	Cube	Price
APSSPB4	1 1/4"	9 5/16"	2 1/4"	1	1	\$177

Can be mounted below worksurfaces or in wire management troughs. Includes (1) circuit 1, (1) circuit 2, (1) circuit IG, (1) circuit 4. (Available for freestanding trough)

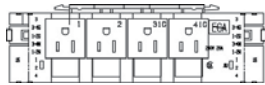

### Double-Sided Power Box (8-Power outlets)

Model#	Depth	Width	Height	Weight	Cube	Price
APSSPB8	2"	8 7/16"	2 1/2"	1	1	\$289

Can be mounted below worksurfaces only. Includes (2) circuit 1, (2) circuit 2, (2) circuit IG, (2) circuit 4. (1) mounting bracket MB

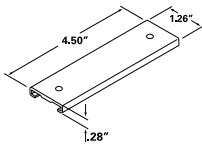

### Power Module Single and Double Sided Data Ready Units

Model#	Depth	Width	Height	Color	Weight	Cube	Price
APSBS4	1 5/8"	10 1/2"	4 1/2"	Silver	1	1	\$857
APSB8	2 1/2"	10 1/2"	4 1/2"	Silver	1	1	\$954

No cut out required. Field install under worksurface or onto a Modesty Panel. Mount hardware included. Date Hardwire Jack CAT 6. Black with Orange Bezel.  
APSBS4: 4 power outlets and 4 RJ45.  
APSB8: 8 power outlets and 4 RJ45 (4 blank caps).

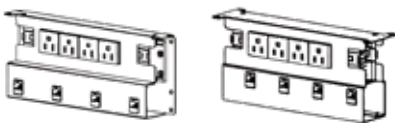

APSBS4

APSB8

### Vertibra Wire Management

Model#	Depth	Width	Height	Weight	Cube	Price
APVMT28	4"	4"	28"	1	1	\$208

Wire management from floor to underside of work surface (Field installed). Finish: Silver. (Available for freestanding trough)



### Rectangular Power Grommet (1-Power, 2-Power USB with adapter, 108" cord)

Model#	Depth	Width	Height	Color	Weight	Cube	Price
APRPG1B	2 1/4"	3 3/4"	3"	Black	2	1	\$448
APRPG1S	2 1/4"	3 3/4"	3"	Silver	2	1	\$448
APRPG1GW	2 1/4"	3 3/4"	3"	Gloss White	2	1	\$448



# apex freestanding troughs



NOTE: Freestanding Troughs Mix Color Option is N/A.

## Trough with Center Panel

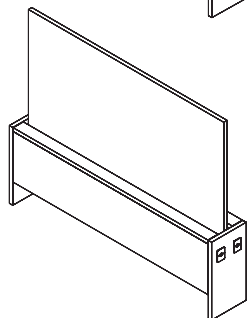
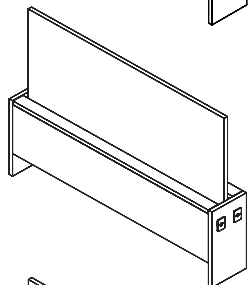
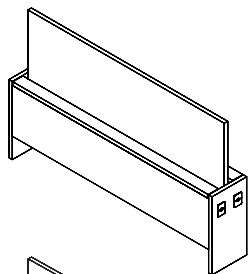
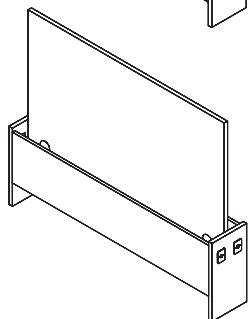
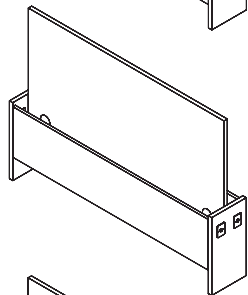
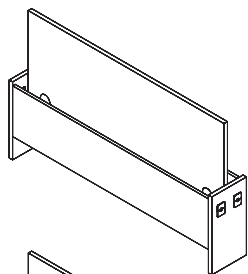

### Trough No Doors with Center Panel, 36"H

Model#	Depth	Width	Height	Price
APWMT4836ND	10"	48"	20/36"	\$743
APWMT5436ND	10"	54"	20/36"	\$776
APWMT6036ND	10"	60"	20/36"	\$811
APWMT6636ND	10"	66"	20/36"	\$844
APWMT7236ND	10"	72"	20/36"	\$883

Silver Square Grommet: 2-left & right end panel, 6 grommet holes inside trough

### Trough No Doors with Center Panel, 42"H

Model#	Depth	Width	Height	Price
APWMT4842ND	10"	48"	20/42"	\$769
APWMT5442ND	10"	54"	20/42"	\$808
APWMT6042ND	10"	60"	20/42"	\$844
APWMT6642ND	10"	66"	20/42"	\$883
APWMT7242ND	10"	72"	20/42"	\$922

Silver Square Grommet: 2-left & right end panel, 6 grommet holes inside trough

### Trough No Doors with Center Panel, 48"H

Model#	Depth	Width	Height	Price
APWMT4848ND	10"	48"	20/48"	\$796
APWMT5448ND	10"	54"	20/48"	\$838
APWMT6048ND	10"	60"	20/48"	\$876
APWMT6648ND	10"	66"	20/48"	\$918
APWMT7248ND	10"	72"	20/48"	\$960

Silver Square Grommet: 2-left & right end panel, 6 grommet holes inside trough

## Trough with Doors & Center Panel

### Trough with Hinged Doors and Center Panel, 36"H

Model#	Depth	Width	Height	Price
APWMT4836WD	10"	48"	20/36"	\$1,016
APWMT5436WD	10"	54"	20/36"	\$1,058
APWMT6036WD	10"	60"	20/36"	\$1,101
APWMT6636WD	10"	66"	20/36"	\$1,139
APWMT7236WD	10"	72"	20/36"	\$1,180

Silver Square Grommet: 2-left & right end panel, 6 grommet holes inside trough

### Trough with Hinged Doors and Center Panel, 42"H

Model#	Depth	Width	Height	Price
APWMT4842WD	10"	48"	20/42"	\$1,043
APWMT5442WD	10"	54"	20/42"	\$1,088
APWMT6042WD	10"	60"	20/42"	\$1,130
APWMT6642WD	10"	66"	20/42"	\$1,176
APWMT7242WD	10"	72"	20/42"	\$1,219

Silver Square Grommet: 2-left & right end panel, 6 grommet holes inside trough

### Trough with Hinged Doors and Center Panel, 48"H

Model#	Depth	Width	Height	Price
APWMT4848WD	10"	48"	20/48"	\$1,071
APWMT5448WD	10"	54"	20/48"	\$1,119
APWMT6048WD	10"	60"	20/48"	\$1,165
APWMT6648WD	10"	66"	20/48"	\$1,210
APWMT7248WD	10"	72"	20/48"	\$1,260

Silver Square Grommet: 2-left & right end panel, 6 grommet holes inside trough

## Trough with Center Panel & End Panel

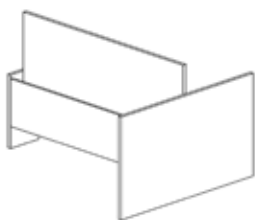

### Trough No Doors with Center Panel and 48"W End Panel, 36"H

Model#	Depth	Width	Height	Price
APWMT4836ND48	10"	48"	20/36"	\$951
APWMT5436ND48	10"	54"	20/36"	\$984
APWMT6036ND48	10"	60"	20/36"	\$1,018
APWMT6636ND48	10"	66"	20/36"	\$1,052
APWMT7236ND48	10"	72"	20/36"	\$1,090

48"W end panel is 28"H. Silver Square Grommet: 2-on 20"H end panel, 6 grommet holes Inside Trough

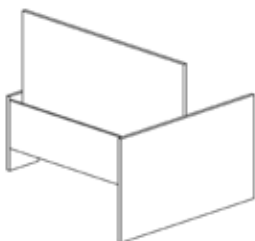

### Trough No Doors with Center Panel and 48"W End Panel, 42"H

Model#	Depth	Width	Height	Price
APWMT4842ND48	10"	48"	20/42"	\$977
APWMT5442ND48	10"	54"	20/42"	\$1,015
APWMT6042ND48	10"	60"	20/42"	\$1,052
APWMT6642ND48	10"	66"	20/42"	\$1,090
APWMT7242ND48	10"	72"	20/42"	\$1,129

48"W end panel is 28"H. Silver Square Grommet: 2-on 20"H end panel, 6 grommet holes Inside Trough

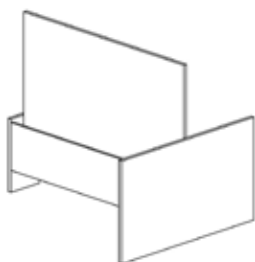

### Trough No Doors with Center Panel and 48"W End Panel, 48"H

Model#	Depth	Width	Height	Price
APWMT4848ND48	10"	48"	20/48"	\$1,002
APWMT5448ND48	10"	54"	20/48"	\$1,045
APWMT6048ND48	10"	60"	20/48"	\$1,083
APWMT6648ND48	10"	66"	20/48"	\$1,126
APWMT7248ND48	10"	72"	20/48"	\$1,167

48"W end panel is 28"H. Silver Square Grommet: 2-on 20"H end panel, 6 grommet holes Inside Trough

## Trough with Doors, Center Panel & End Panel

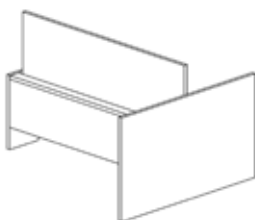

### Trough with Hinged Doors Center Panel and 48"W End Panel, 36"H

Model#	Depth	Width	Height	Price
APWMT4836WD48	10"	48"	20/36"	\$1,224
APWMT5436WD48	10"	54"	20/36"	\$1,266
APWMT6036WD48	10"	60"	20/36"	\$1,308
APWMT6636WD48	10"	66"	20/36"	\$1,346
APWMT7236WD48	10"	72"	20/36"	\$1,388

48"W end panel is 28"H. Silver Square Grommet: 2-on 20"H end panel, 6 grommet holes Inside Trough

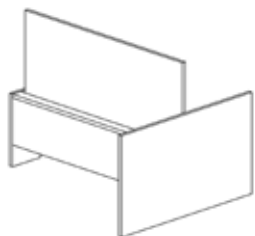

### Trough with Hinged Doors Center Panel and 48"W End Panel, 42"H

Model#	Depth	Width	Height	Price
APWMT4842WD48	10"	48"	20/42"	\$1,251
APWMT5442WD48	10"	54"	20/42"	\$1,296
APWMT6042WD48	10"	60"	20/42"	\$1,338
APWMT6642WD48	10"	66"	20/42"	\$1,383
APWMT7242WD48	10"	72"	20/42"	\$1,426

48"W end panel is 28"H. Silver Square Grommet: 2-on 20"H end panel, 6 grommet holes Inside Trough

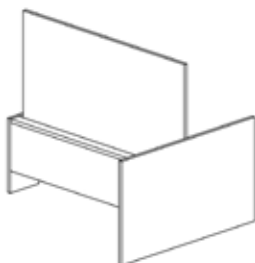

### Trough with Hinged Doors Center Panel and 48"W End Panel, 48"H

Model#	Depth	Width	Height	Price
APWMT4848WD48	10"	48"	20/48"	\$1,278
APWMT5448WD48	10"	54"	20/48"	\$1,331
APWMT6048WD48	10"	60"	20/48"	\$1,373
APWMT6648WD48	10"	66"	20/48"	\$1,418
APWMT7248WD48	10"	72"	20/48"	\$1,467

48"W end panel is 28"H. Silver Square Grommet: 2-on 20"H end panel, 6 grommet holes Inside Trough

## Trough with Center Panel & End Panel

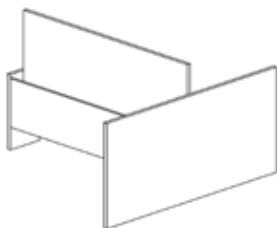

### Trough No Doors with Center Panel and 60"W End Panel, 36"H

Model#	Depth	Width	Height	Price
APWMT4836ND60	10"	48"	20/36"	\$991
APWMT5436ND60	10"	54"	20/36"	\$1,025
APWMT6036ND60	10"	60"	20/36"	\$1,060
APWMT6636ND60	10"	66"	20/36"	\$1,092
APWMT7236ND60	10"	72"	20/36"	\$1,131

60"W end panel is 28"H. Silver Square Grommet: 2-on 20"H end panel, 6 grommet holes inside trough

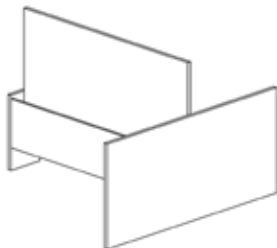

### Trough No Doors with Center Panel and 60"W End Panel, 42"H

Model#	Depth	Width	Height	Price
APWMT4842ND60	10"	48"	20/42"	\$1,017
APWMT5442ND60	10"	54"	20/42"	\$1,055
APWMT6042ND60	10"	60"	20/42"	\$1,092
APWMT6642ND60	10"	66"	20/42"	\$1,131
APWMT7242ND60	10"	72"	20/42"	\$1,169

60"W end panel is 28"H. Silver Square Grommet: 2-on 20"H end panel, 6 grommet holes inside trough

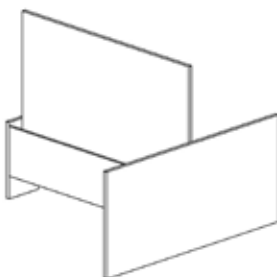

### Trough No Doors with Center Panel and 60"W End Panel, 48"H

Model#	Depth	Width	Height	Price
APWMT4848ND60	10"	48"	20/48"	\$1,044
APWMT5448ND60	10"	54"	20/48"	\$1,085
APWMT6048ND60	10"	60"	20/48"	\$1,123
APWMT6648ND60	10"	66"	20/48"	\$1,166
APWMT7248ND60	10"	72"	20/48"	\$1,207

60"W end panel is 28"H. Silver Square Grommet: 2-on 20"H end panel, 6 grommet holes inside trough

## Trough with Doors, Center Panel & End Panel

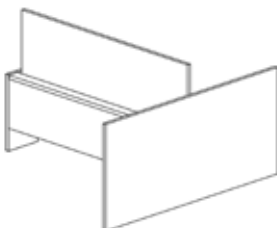

### Trough with Hinged Doors Center Panel and 60"W End Panel, 36"H

Model#	Depth	Width	Height	Price
APWMT4836WD60	10"	48"	20/36"	\$1,264
APWMT5436WD60	10"	54"	20/36"	\$1,307
APWMT6036WD60	10"	60"	20/36"	\$1,348
APWMT6636WD60	10"	66"	20/36"	\$1,387
APWMT7236WD60	10"	72"	20/36"	\$1,429

60"W end panel is 28"H. Silver Square Grommet: 2-on 20"H end panel, 6 grommet holes inside trough

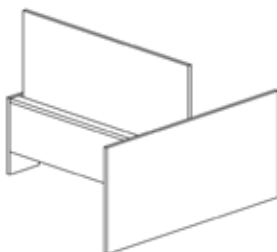

### Trough with Hinged Doors Center Panel and 60"W End Panel, 42"H

Model#	Depth	Width	Height	Price
APWMT4842WD60	10"	48"	20/42"	\$1,291
APWMT5442WD60	10"	54"	20/42"	\$1,337
APWMT6042WD60	10"	60"	20/42"	\$1,379
APWMT6642WD60	10"	66"	20/42"	\$1,424
APWMT7242WD60	10"	72"	20/42"	\$1,466

60"W end panel is 28"H. Silver Square Grommet: 2-on 20"H end panel, 6 grommet holes inside trough

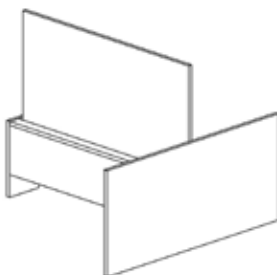

### Trough with Hinged Doors Center Panel and 60"W End Panel, 48"H

Model#	Depth	Width	Height	Price
APWMT4848WD60	10"	48"	20/48"	\$1,318
APWMT5448WD60	10"	54"	20/48"	\$1,369
APWMT6048WD60	10"	60"	20/48"	\$1,413
APWMT6648WD60	10"	66"	20/48"	\$1,459
APWMT7248WD60	10"	72"	20/48"	\$1,508

60"W end panel is 28"H. Silver Square Grommet: 2-on 20"H end panel, 6 grommet holes inside trough



## Trough with Center Panel & Privacy Screen (Privacy Screen Adds 12"H to Height)

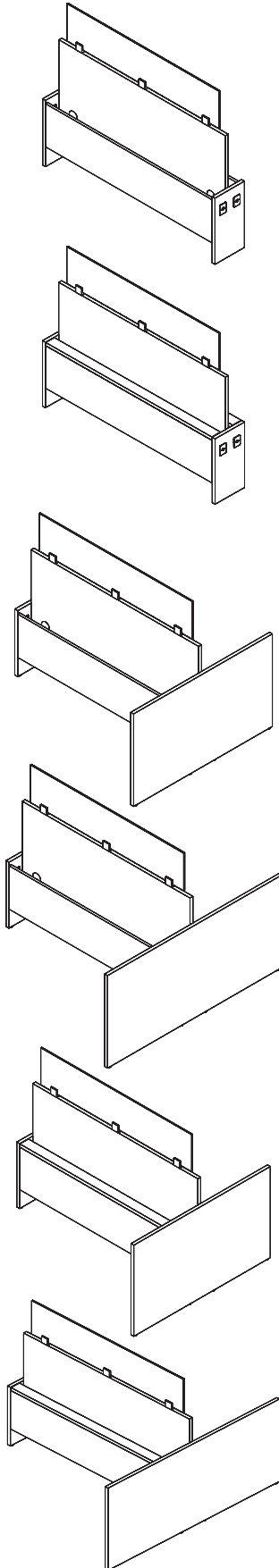

### Trough No Doors with Center Panel & Frosted Acrylic Screen, 36"H

Model#	Depth	Width	Height	Privacy Screen	Price
APWMT4836NDPS	10"	48"	20/36"	APPSU48	\$1,192
APWMT5436NDPS	10"	54"	20/36"	APPSU54	\$1,419
APWMT6036NDPS	10"	60"	20/36"	APPSU60	\$1,460
APWMT6636NDPS	10"	66"	20/36"	APPSU66	\$1,500
APWMT7236NDPS	10"	72"	20/36"	APPSU72	\$1,543

Silver Square Grommet: 2-left & right end panel, 6 grommet holes inside trough

### Trough with Hinged Doors, Center Panel & Frosted Acrylic Screen, 36"H

Model#	Depth	Width	Height	Privacy Screen	Price
APWMT4836WDPS	10"	48"	20/36"	APPSU48	\$1,465
APWMT5436WDPS	10"	54"	20/36"	APPSU54	\$1,701
APWMT6036WDPS	10"	60"	20/36"	APPSU60	\$1,748
APWMT6636WDPS	10"	66"	20/36"	APPSU66	\$1,794
APWMT7236WDPS	10"	72"	20/36"	APPSU72	\$1,837

Silver Square Grommet: 2-left & right end panel, 6 grommet holes inside trough

## Trough with Center Panel, Privacy Screen & End Panel (Privacy Screen Adds 12"H to Height)

### Trough No Doors with Center Panel, 48"W End Panel & Frosted Acrylic Screen, 36"H

Model#	Depth	Width	Height	Privacy Screen	Price
APWMT4836ND48PS	10"	48"	20/36"	APPSU48	\$1,399
APWMT5436ND48PS	10"	54"	20/36"	APPSU54	\$1,626
APWMT6036ND48PS	10"	60"	20/36"	APPSU60	\$1,668
APWMT6636ND48PS	10"	66"	20/36"	APPSU66	\$1,707
APWMT7236ND48PS	10"	72"	20/36"	APPSU72	\$1,752

48"W end panel is 28"H. Silver Square Grommet: 2-on 20"H end panel, 6 grommet holes inside trough

### Trough No Doors with Center Panel, 60"W End Panel & Frosted Acrylic Screen, 36"H

Model#	Depth	Width	Height	Privacy Screen	Price
APWMT4836ND60PS	10"	48"	20/36"	APPSU48	\$1,439
APWMT5436ND60PS	10"	54"	20/36"	APPSU54	\$1,668
APWMT6036ND60PS	10"	60"	20/36"	APPSU60	\$1,708
APWMT6636ND60PS	10"	66"	20/36"	APPSU66	\$1,747
APWMT7236ND60PS	10"	72"	20/36"	APPSU72	\$1,793

60"W end panel is 28"H. Silver Square Grommet: 2-on 20"H end panel, 6 grommet holes inside trough

### Trough w/Hinged Doors Center Panel, 48"W End Panel & Frosted Acrylic Screen, 36"H

Model#	Depth	Width	Height	Privacy Screen	Price
APWMT4836WD48PS	10"	48"	20/36"	APPSU48	\$1,673
APWMT5436WD48PS	10"	54"	20/36"	APPSU54	\$1,910
APWMT6036WD48PS	10"	60"	20/36"	APPSU60	\$1,957
APWMT6636WD48PS	10"	66"	20/36"	APPSU66	\$2,001
APWMT7236WD48PS	10"	72"	20/36"	APPSU72	\$2,048

48"W end panel is 28"H. Silver Square Grommet: 2-on 20"H end panel, 6 grommet holes inside trough

### Trough w/Hinged Doors Center Panel, 60"W End Panel & Frosted Acrylic Screen, 36"H

Model#	Depth	Width	Height	Privacy Screen	Price
APWMT4836WD60PS	10"	48"	20/36"	APPSU48	\$1,714
APWMT5436WD60PS	10"	54"	20/36"	APPSU54	\$1,950
APWMT6036WD60PS	10"	60"	20/36"	APPSU60	\$1,998
APWMT6636WD60PS	10"	66"	20/36"	APPSU66	\$2,042
APWMT7236WD60PS	10"	72"	20/36"	APPSU72	\$2,090

60"W end panel is 28"H. Silver Square Grommet: 2-on 20"H end panel, 6 grommet holes inside trough

## Worksurfaces for Freestanding Troughs (For Freestanding Troughs)

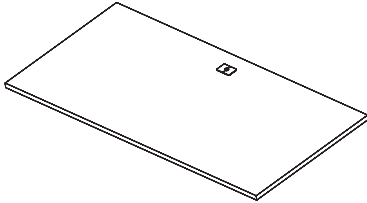

### Rectangular Worksurfaces, Square Silver Grommet

Model#	Depth	Width	Height	Trough Width	Price
APRT2447	24"	47"	1"	48"	\$274
APRT2453	24"	53"	1"	54"	\$347
APRT2459	24"	59"	1"	60"	\$363
APRT2465	24"	65"	1"	66"	\$389
APRT2471	24"	71"	1"	72"	\$407
APRT3047	30"	47"	1"	48"	\$301
APRT3053	30"	53"	1"	54"	\$389
APRT3059	30"	59"	1"	60"	\$399
APRT3065	30"	65"	1"	66"	\$432
APRT3071	30"	71"	1"	72"	\$455

Center silver square grommet standard. Tops are designed to fit freestanding troughs.

## Adjustable Bases (For Worksurfaces)

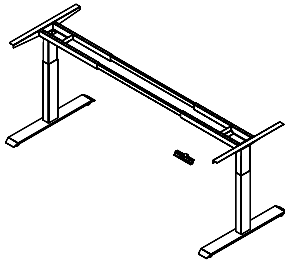

### Adjustable Height Electrical Base

Model#	Base(D)	Base (W)	Height	Fits Top Size	Color	Weight	Cube	Price
MMLEGAHE24S	22"	47-72"	23 1/2-49"	24"D-72"W	Silver	64	1	\$1,407
MMLEGAHE24B	22"	47-72"	23 1/2-49"	24"D-72"W	Black	64	1	\$1,407
MMLEGAHE24W	22"	47-72"	23 1/2-49"	24"D-72"W	White	64	1	\$1,407
MMLEGAHE30S	28"	47-72"	23 1/2-49"	30"D-72"W	Silver	64	1	\$1,407
MMLEGAHE30B	28"	47-72"	23 1/2-49"	30"D-72"W	Black	64	1	\$1,407
MMLEGAHE30W	28"	47-72"	23 1/2-49"	30"D-72"W	White	64	1	\$1,407

2 Stage base.

## Tackboards (For Freestanding Trough Center Panels)

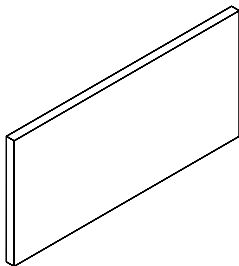

### Tackboard (For 42"H & 48"H troughs)

Model#	Depth	Width	Height	Fits Trough Width	Price
APTKBD1948	1/2"	46"	19"	48"W	\$485
APTKBD1954	1/2"	52"	19"	54"W	\$498
APTKBD1960	1/2"	58"	19"	60"W	\$563
APTKBD1966	1/2"	64"	19"	66"W	\$603
APTKBD1972	1/2"	70"	19"	72"W	\$643

Tackboard fabric options refer to pricer p. 212. Tackboards N/A for 36"H troughs.



# apex series

## Apex Accessories and Upgrades

HPL Modesty & Privacy  
Screen, HPL Color Options TFM Standard Colors

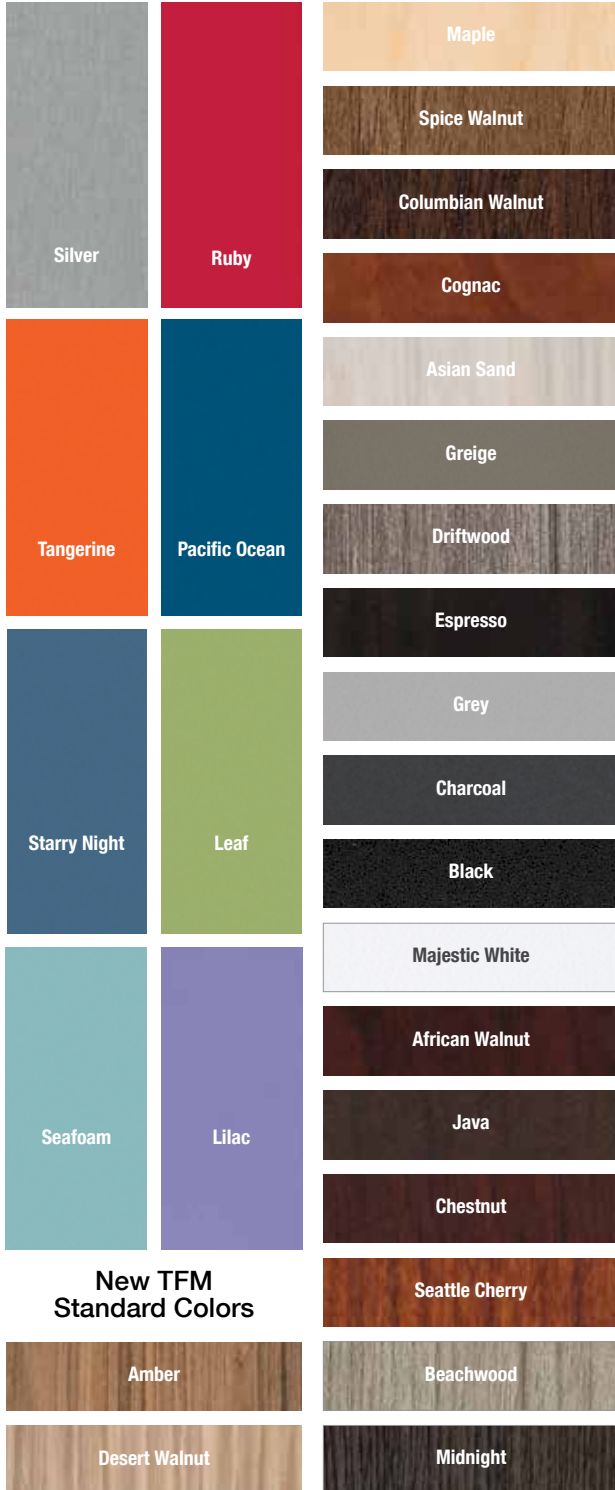

### Handle



**APH1**  
Smooth, curved edge handle in brushed aluminum

### Power Management



**APSSPB4/ APSSPB8**  
Single sided power box with four power outlets/  
Double sided power box with eight power outlets



**APESC72**  
System hardware electrical  
starter cable



**APDCE**  
Daisy chain electrical cable



**APSFC12**  
Split Cable



**APRPG**  
Rectangular Power Grommet



**APVMT28**  
Vertebra Wire Manager

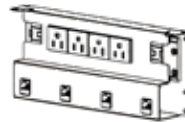

**APSBS4**  
Power Module Single Sided  
Data Ready

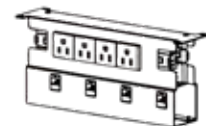

**APSBD8**  
Power Module Double Sided  
Data Ready

### Grommet



**APRG15**  
Standard Rectangular Grommet - Silver

NOTE: Freestanding Troughs Mix Color Options is N/A.